

Part number

CHPW 48 LS



Surface mounting housing, W-TYPE series, with 1 lever, Pg36 cable entry, size "104.62", with metal cover

Product description

Product type	Surface mounting housing
Series	W-TYPE
Closing type	With 1 lever
Size	Size 104.62
Cable entry	With cable entry Pg36
Specification	With metal cover

Technical data

IP degree of protection	IP65
--------------------------------	------

Further technical details

Weight	1.182,00 g
Operating temperature range (min, max)	-40°C...+125°C

Material properties

Other materials	Lever: Stainless steel, polyamide (PA)
Colour	RAL 9005 black
RoHs conformity	Compliant
China RoHs - EFUP	E
REACH SVHC substances	No

Approvals / Standards

Certifications	DNV, BV
UL	ECBT2
cUL	ECBT8

General ordering information

EAN13 code	8015747024044
-------------------	---------------

Packaging Information

Packaging length	305,00 mm
Packaging height	180,00 mm
Packaging width	275,00 mm
Packaging weight	4,93 kg
Packaging volume	15,10 dm ³
Packaging description	Carton box
Packaging quantity	4 Pcs
Packaging EAN code	8015747024051
Sub-packaging weight	1,23 kg
Sub-packaging description	Plastic packaging
Sub-packaging quantity	1 Pcs
Sub-packaging EAN barcode	8015747024068

Part number

CHPW 48 LS



Catalogue drawings

CHIW LS

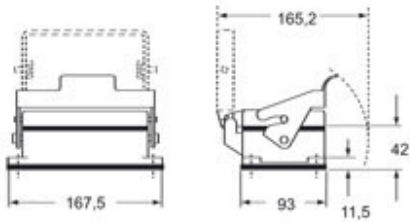

CHPW LS MHPW LS

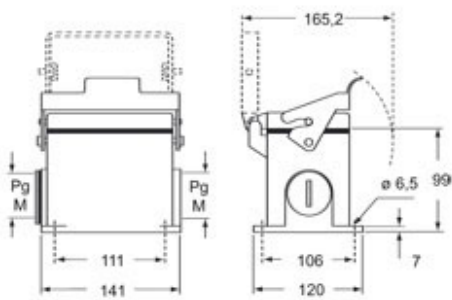

Notes