

Part number

CHP 10 LS2



Surface mounting housing, C-TYPE series, with 1 lever, Pg16 x 2 cable entry, size "57.27", with metal cover

Product description		Material properties	
Product type	Surface mounting housing	Other materials	Lever: Stainless steel, polyamide (PA) Gasket: NBR
Series	C-TYPE	Colour	RAL 7040 grey
Closing type	With 1 lever	RoHs conformity	Compliant
Size	Size 57.27	China RoHs - EFUP	E
Cable entry	With cable entry Pg16 x 2	REACH SVHC substances	No
Specification	With metal cover	Approvals / Standards	
Technical data		Certifications	DNV, BV
IP degree of protection	IP65	UL	ECBT2
Further technical details		cUL	ECBT8
Weight	285,00 g	General ordering information	
Operating temperature range (min, max)	-40°C...+125°C	EAN13 code	8015747021937
		Packaging Information	
		Packaging length	475,00 mm
		Packaging height	170,00 mm
		Packaging width	150,00 mm
		Packaging weight	3,30 kg
		Packaging volume	12,11 dm ³
		Packaging description	Carton box
		Packaging quantity	10 Pcs
		Packaging EAN code	8015747021944
		Sub-packaging weight	1,65 kg
		Sub-packaging description	Carton box
		Sub-packaging quantity	5 Pcs
		Sub-packaging EAN barcode	8015747021951

Part number

CHP 10 LS2



Catalogue drawings

CHP L - CAP L MHP L - MAP L



CHP LS - CAP LS MHP LS - MAP LS

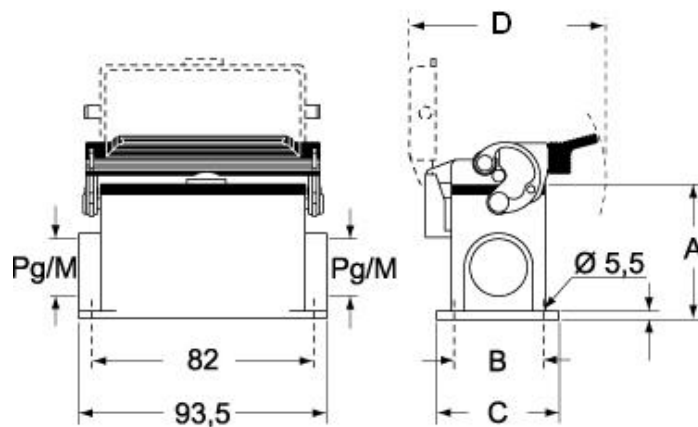

Notes