

Part number

CHCE 16 G



Cover, E-Xtreme® C-TYPE series, with 2 levers, size "77.27", with loop

Product description

Product type	Cover
Series	E-Xtreme® C-TYPE
Closing type	With 2 levers
Size	Size 77.27
Specification	With loop

Technical data

IP degree of protection	IP66 / IP67 / IP69
--------------------------------	--------------------

Further technical details

Weight	160,00 g
Operating temperature range (min, max)	-40°C...+125°C

Material properties

Main material	Aluminium die-cast
Other materials	Lever: Stainless steel, polyamide (PA) Gasket: FKM Loop: Stainless steel, galvanized brass
Colour	RAL 7016 grey
RoHs conformity	Compliant
China RoHs - EFUP	E
REACH SVHC substances	No

Approvals / Standards

Certifications	DNV, BV
UL	ECBT2
cUL	ECBT8

General ordering information

EAN13 code	8015747274913
eCl@ss 8.1	27440208
ETIM 7.0	EC002314

Packaging Information

Packaging length	180,00 mm
Packaging height	210,00 mm
Packaging width	330,00 mm
Packaging weight	3,56 kg
Packaging volume	12,47 dm ³
Packaging description	Carton box
Packaging quantity	20 Pcs
Packaging EAN code	8015747274920
Sub-packaging weight	0,18 kg
Sub-packaging description	Plastic bag
Sub-packaging quantity	1 Pcs
Sub-packaging EAN barcode	8015747274937

Part number

CHCE 16 G



Catalogue drawings

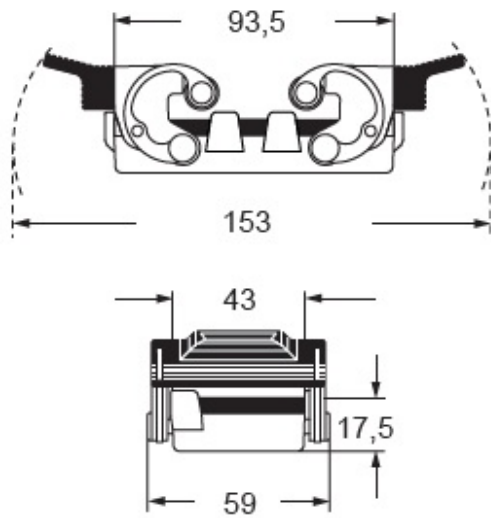

Notes