

Part number

# CDMA 1.5



Male crimp contact, CD series, 10 A, turned silver plated, wire cross section 1,5 mm<sup>2</sup>, AWG 16

## Product description

<b>Product type</b>	Crimp contact
<b>Series</b>	CD
<b>Gender</b>	Male

## Technical data

<b>Current</b>	10 A
<b>Wire cross-section</b>	1,50 mm <sup>2</sup>
<b>AWG size</b>	16
<b>Contact type</b>	Turned silver plated

## Further technical details

<b>Contact resistance</b>	≤ 0,3 mΩ
<b>Weight</b>	0,63 g
<b>Operating temperature range (min, max)</b>	-40°C ... +125°C
<b>Conductors stripping length</b>	8 mm

## Material properties

<b>Main material</b>	Copper alloy
<b>RoHs conformity</b>	Compliant with exemption 6(c): copper alloy containing up to 4% lead by weight
<b>China RoHs - EFUP</b>	50
<b>REACH SVHC substances</b>	Yes Lead
<b>SCIP number</b>	C0979fba-9907-458f-a94a-db781440f273

## Approvals / Standards

<b>Certifications</b>	CSA, EAC
<b>UL</b>	ECBT2

## General ordering information

<b>EAN13 code</b>	8015747015400
<b>eCl@ss 8.1</b>	27440204
<b>ETIM 7.0</b>	EC000796

## Packaging Information

<b>Packaging length</b>	112,00 mm
<b>Packaging height</b>	95,00 mm
<b>Packaging width</b>	117,00 mm
<b>Packaging weight</b>	1,18 kg
<b>Packaging volume</b>	1,24 dm <sup>3</sup>
<b>Packaging description</b>	Carton box
<b>Packaging quantity</b>	1600 Pcs
<b>Packaging EAN code</b>	8015747104050
<b>Sub-packaging length</b>	50,00 mm
<b>Sub-packaging height</b>	44,00 mm
<b>Sub-packaging width</b>	50,00 mm
<b>Sub-packaging weight</b>	0,15 kg
<b>Sub-packaging volume</b>	0,11 dm <sup>3</sup>
<b>Sub-packaging description</b>	Plastic box
<b>Sub-packaging quantity</b>	200 Pcs
<b>Sub-packaging EAN barcode</b>	8015747015417

Part number

# CDMA 1.5



## Catalogue drawings

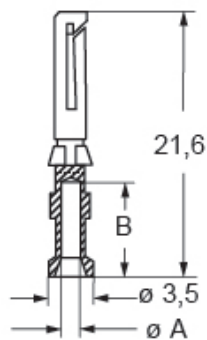
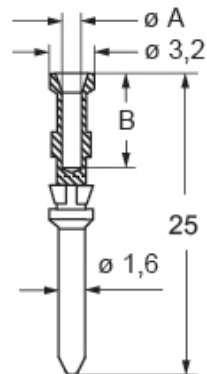

### CDF and CDM contacts

conductor section mm <sup>2</sup>	conductor slot $\varnothing A$ (mm)	conductors stripping length B (mm)
0,14-0,37	0,9	8
0,5	1,1	8
0,75	1,3	8
1,0	1,45	8
1,5	1,8	8
2,5	2,2	6

Notes

## California Proposition 65 Information



### **WARNING**

This product can expose you to lead and its compounds, known to the State of California to cause cancer and/or reproductive toxicity. For more information go to [www.P65Warnings.ca.gov](http://www.P65Warnings.ca.gov).

---