

Part number

# TMAP 06 L32



Surface mounting housing, T-TYPE series, with 1 lever, M32 cable entry, size "44.27", high construction

| Product description                           |                          | Material properties              |   |
|---|--------------------------|----------------------------------|---|
| <b>Product type</b>                           | Surface mounting housing | <b>Main material</b>             | Polypropylene (PP)                                  |
| <b>Series</b>                                 | T-TYPE                   | <b>Other materials</b>           | Lever: Polyamide (PA)<br>Gasket: polyurethane (PUR) |
| <b>Closing type</b>                           | With 1 lever             | <b>Colour</b>                    | RAL 7012 grey, RAL 7001 grey                        |
| <b>Size</b>                                   | Size 44.27               | <b>RoHs conformity</b>           | Compliant   |
| <b>Cable entry</b>                            | With cable entry<br>M32  | <b>China RoHs - EFUP</b>         | E   |
| <b>Specification</b>                          | High construction        | <b>REACH SVHC substances</b>     | No  |
| Technical data                                |                          | Approvals / Standards            |   |
| <b>IP degree of protection</b>                | IP65                     | <b>UL</b>                        | ECBT2   |
| Further technical details                     |                          | <b>cUL</b>                       | ECBT8   |
| <b>Weight</b>                                 | 123,00 g                 | General ordering information     |   |
| <b>Operating temperature range (min, max)</b> | -40°C ... +90°C          | <b>EAN13 code</b>                | 8015747168588                                       |
|   |                          | <b>eCl@ss 8.1</b>                | 27440202  |
|   |                          | <b>ETIM 7.0</b>                  | EC000437  |
|   |                          | Packaging Information            |   |
|   |                          | <b>Packaging length</b>          | 180,00 mm   |
|   |                          | <b>Packaging height</b>          | 210,00 mm   |
|   |                          | <b>Packaging width</b>           | 330,00 mm   |
|   |                          | <b>Packaging weight</b>          | 2,46 kg   |
|   |                          | <b>Packaging volume</b>          | 12,47 dm <sup>3</sup>                               |
|   |                          | <b>Packaging description</b>     | Carton box  |
|   |                          | <b>Packaging quantity</b>        | 20 Pcs  |
|   |                          | <b>Packaging EAN code</b>        | 8015747170222                                       |
|   |                          | <b>Sub-packaging weight</b>      | 0,62 kg   |
|   |                          | <b>Sub-packaging description</b> | Plastic packaging                                   |
|   |                          | <b>Sub-packaging quantity</b>    | 5 Pcs   |
|   |                          | <b>Sub-packaging EAN barcode</b> | 8015747170239                                       |

Part number

# TMAP 06 L32



## Catalogue drawings

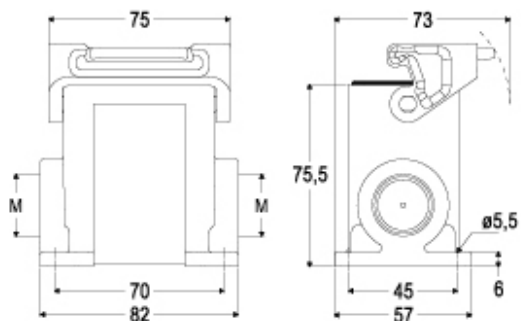

---

## Notes

Dimensions shown in mm are not binding and may be changed without notice.

---