

Part number

TM 6393 SP



Interlocked switched socket-outlet, TM series,
2 poles + PE, 9 h (red), 63 A, 380 ÷ 415 V,
without fuse-carrier, with base box

Product description

Product type	Interlocked switched socket-outlet
Series	TM..SP/KSP
N. of poles	2 poles + 
Clock position	9
Size	145 x 565 x 18 mm
Specification	Without fuse-carrier With base box

Technical data

Current	63 A
Voltage	380 ÷ 415 V
IP degree of protection	IP66 / IP67

Further technical details

Operating temperature range (min, max)	-25°C ... +40°C
UL 94 flammability rating	V-0 (insert), V-2 (enclosure)
IK rating (impact degree of protection)	IK10

Material properties

Colour	RAL 7012 grey, RAL 3000 red
---------------	-----------------------------

Approvals / Standards

Reference standard	EN 60309-1, -2 e -4
---------------------------	---------------------

General ordering information

EAN13 code	8015747100632
-------------------	---------------

Part number

TM 6393 SP



Catalogue drawings

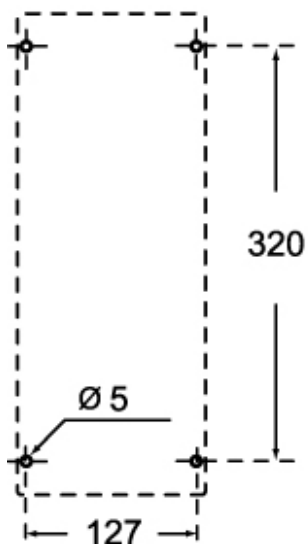

Notes

Dimensions shown in mm are not binding and may be changed without notice.