

Part number

TM 6363 IR



Interlocked switched socket-outlet, TM series, 2 poles + PE, 6 h (blue), 63 A, 200 ÷ 250 V, with compartment for modular units, 6 DIN-rail modules EN 60715, with base box

Product description

Product type	Interlocked switched socket-outlet
Series	TM..IR/KIR
N. of poles	2 poles + 
Clock position	6
Size	145 x 565 x 18 mm
Specification	With compartment for modular units, 6 DIN-rail modules EN 60715 With base box

Technical data

Current	63 A
Voltage	200 ÷ 250 V
IP degree of protection	IP66 / IP67
Further technical details	
Weight	3.135,00 g
Operating temperature range (min, max)	-25°C ... +40°C
UL 94 flammability rating	V-0 (insert), V-2 (enclosure)
IK rating (impact degree of protection)	IK10

Material properties

Colour	RAL 7012 grey, RAL 5015 blue
RoHs conformity	Compliant with exemption 6(c): copper alloy containing up to 4% lead by weight
China RoHs - EFUP	50
REACH SVHC substances	Yes Lead
SCIP number	F6799547-ab84-42f2-938f-233ba663766d

Approvals / Standards

Reference standard	EN 60309-1, -2 e -4
---------------------------	---------------------

General ordering information

EAN13 code	8015747092456
-------------------	---------------

Packaging Information

Sub-packaging length	150,00 mm
Sub-packaging height	188,00 mm
Sub-packaging width	430,00 mm
Sub-packaging weight	3,14 kg
Sub-packaging volume	12,13 dm ³
Sub-packaging description	Carton box
Sub-packaging quantity	1 Pcs
Sub-packaging EAN barcode	8015747092470

Part number

TM 6363 IR



Catalogue drawings

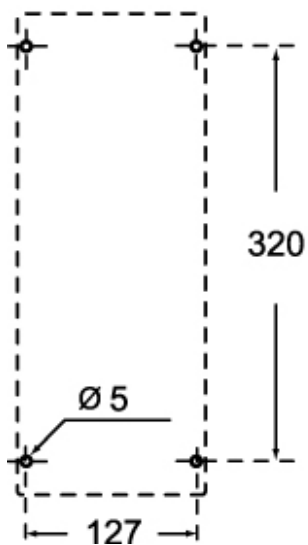

Notes

Dimensions shown in mm are not binding and may be changed without notice.