

Part number

# TM 6344 IR



Interlocked switched socket-outlet, TM series, 3 poles + PE, 4 h (yellow), 63 A, 100 ÷ 130 V, with compartment for modular units, 6 DIN-rail modules EN 60715, with base box

#### Product description

<b>Product type</b>	Interlocked switched socket-outlet
<b>Series</b>	TM..IR/KIR
<b>N. of poles</b>	3 poles + 
<b>Clock position</b>	4
<b>Size</b>	145 x 565 x 18 mm
<b>Specification</b>	With compartment for modular units, 6 DIN-rail modules EN 60715 With base box

#### Technical data

<b>Current</b>	63 A
<b>Voltage</b>	100 ÷ 130 V
<b>IP degree of protection</b>	IP66 / IP67

#### Further technical details

<b>Operating temperature range (min, max)</b>	-25°C ... +40°C
<b>UL 94 flammability rating</b>	V-0 (insert), V-2 (enclosure)
<b>IK rating (impact degree of protection)</b>	IK10

#### Material properties

<b>Colour</b>	RAL 7012 grey, RAL 1021 yellow
---------------	--------------------------------

#### Approvals / Standards

<b>Reference standard</b>	EN 60309-1, -2 e -4
---------------------------	---------------------

#### General ordering information

<b>EAN13 code</b>	8015747092395
-------------------	---------------

#### Packaging Information

<b>Sub-packaging description</b>	Carton box
<b>Sub-packaging quantity</b>	1 Pcs
<b>Sub-packaging EAN barcode</b>	8015747108829

Part number

# TM 6344 IR



Catalogue drawings

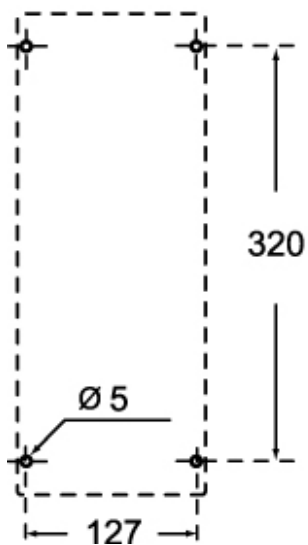

## Notes

Dimensions shown in mm are not binding and may be changed without notice.