

Part number

TM 63115 IR



Interlocked switched socket-outlet, TM series, 3 poles + N + PE, 11 h (red), 63 A, 250/440 ÷ 265/460 V, with compartment for modular units, 6 DIN-rail modules EN 60715, with base box

Product description

Product type	Interlocked switched socket-outlet
Series	TM..IR/KIR
N. of poles	3 poles + N + 
Clock position	11
Specification	With compartment for modular units, 6 DIN-rail modules EN 60715 With base box

Technical data

Current	63 A
Voltage	250/440V ÷ 265/460V
IP degree of protection	IP66 / IP67

Further technical details

Operating temperature range (min, max)	-25°C ... +40°C
UL 94 flammability rating	V-0 (insert), V-2 (enclosure)
IK rating (impact degree of protection)	IK10

Material properties

Colour	RAL 7012 grey, RAL 3000 red
---------------	-----------------------------

Approvals / Standards

Reference standard	EN 60309-1, -2 e -4
---------------------------	---------------------

General ordering information

EAN13 code	8015747163460
-------------------	---------------

Part number

TM 63115 IR



Catalogue drawings

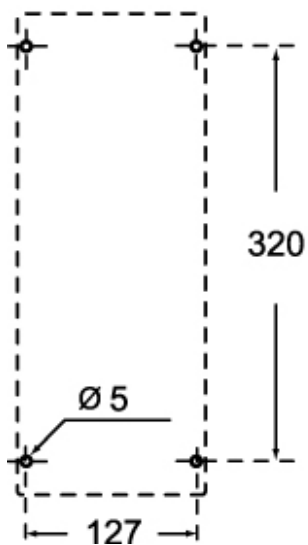

Notes

Dimensions shown in mm are not binding and may be changed without notice.