

Part number

# TM 3275KIR



Interlocked switched socket-outlet, TM series, 3 poles + N + PE, 7 h (black), 32 A, 277/480 ÷ 288/500 V, with compartment for modular units, 4,5 DIN-rail modules EN 60715, with base box

#### Product description

<b>Product type</b>	Interlocked switched socket-outlet
<b>Series</b>	TM..IR/KIR
<b>N. of poles</b>	3 poles + N + 
<b>Clock position</b>	7
<b>Specification</b>	With compartment for modular units, 4,5 DIN-rail modules EN 60715 With base box

#### Technical data

<b>Current</b>	32 A
<b>Voltage</b>	277/480 ÷ 288/500 V
<b>IP degree of protection</b>	IP66 / IP67

#### Further technical details

<b>Weight</b>	1.510,00 g
<b>Operating temperature range (min, max)</b>	-25°C ... +40°C
<b>UL 94 flammability rating</b>	V-2
<b>IK rating (impact degree of protection)</b>	IK10

#### Material properties

<b>Colour</b>	RAL 7012 grey, RAL 9005 black
---------------	-------------------------------

#### Approvals / Standards

<b>Reference standard</b>	EN 60309-1, -2 e -4
---------------------------	---------------------

#### General ordering information

<b>EAN13 code</b>	8015747126397
-------------------	---------------

Part number

# TM 3275KIR



Catalogue drawings

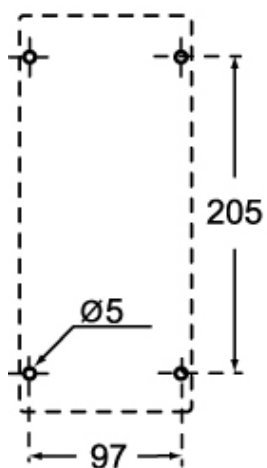
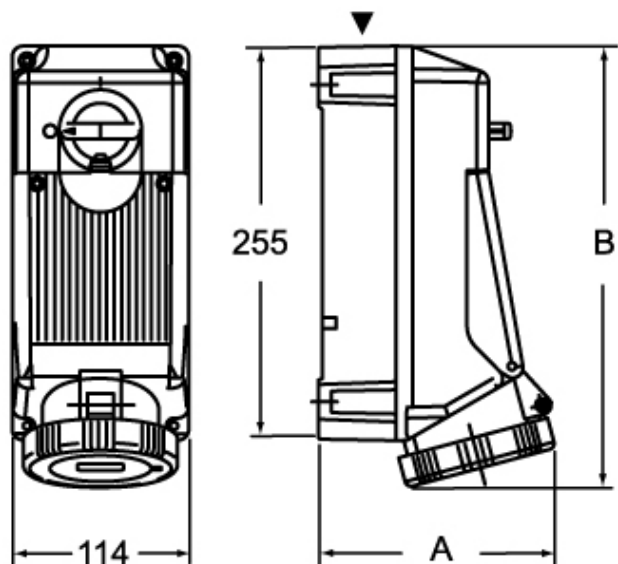

	A	B
<b>2P+⊕</b>	133	276
<b>3P+⊕</b>	135	276
<b>3P+N+⊕</b>	140	277

## Notes

Dimensions shown in mm are not binding and may be changed without notice.