

Part number

TM 1414 DB



Box, TM series, with fixed cover, for TM 1456 TB plate

Product description		Material properties	
Product type	Box	Colour	RAL 7012 grey
Series	TM		Compliant with exemption
Specification	With fixed cover For TM 1456 TB plate	RoHs conformity	6(c): copper alloy containing up to 4% lead by weight
Technical data		China RoHs - EFUP	50
IP degree of protection	IP66 / IP67	REACH SVHC substances	Yes Lead
Further technical details		SCIP number	B0214dad-d2d9-4e91-a5b4-f4c9b4612083
Weight	469,00 g	General ordering information	
Operating temperature range (min, max)	-25°C ... +40°C	EAN13 code	8015747089388
IK rating (impact degree of protection)	IK10	Packaging Information	
		Packaging length	500,00 mm
		Packaging height	325,00 mm
		Packaging width	310,00 mm
		Packaging weight	10,10 kg
		Packaging volume	50,38 dm ³
		Packaging description	Carton box
		Packaging quantity	20 Pcs
		Packaging EAN code	8015747089395
		Sub-packaging weight	0,51 kg
		Sub-packaging description	Plastic packaging
		Sub-packaging quantity	1 Pcs
		Sub-packaging EAN barcode	8015747089401

Part number

TM 1414 DB



Catalogue drawings

TM 1114 DB

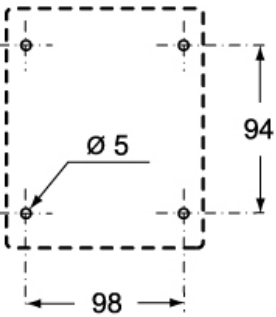
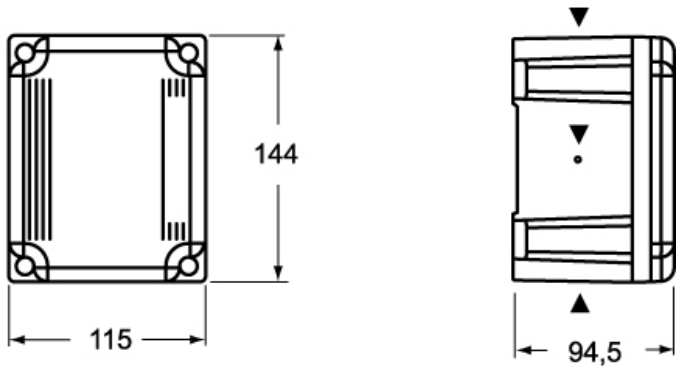

TM 1414 DB

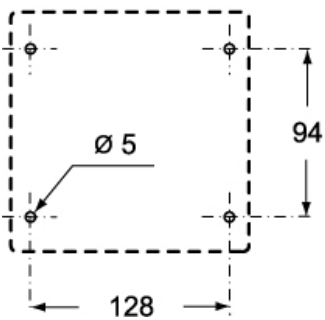
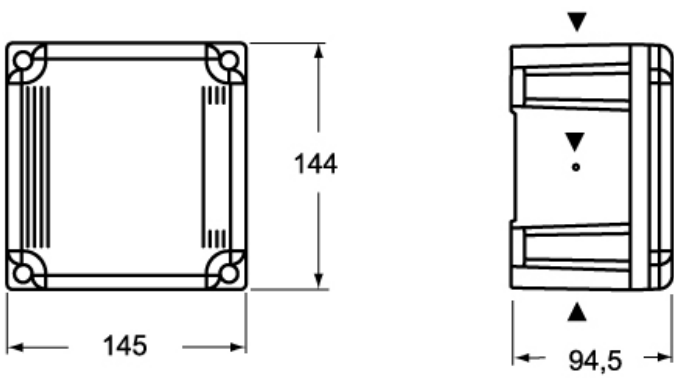

Notes

Dimensions shown in mm are not binding and may be changed without notice.
