

Part number  
**SQ 1695**



Interlocked switched socket-outlet, SQ series,  
 3 poles + N + PE, 9 h (blue), 16 A, 120/208 ÷  
 144/250 V

**Product description**

<b>Product type</b>	Interlocked switched socket-outlet
<b>Series</b>	SQ
<b>N. of poles</b>	3 poles + N +
<b>Clock position</b>	9
<b>Size</b>	Socket centre distance 115 x 144 mm

**Technical data**

<b>Current</b>	16 A
<b>Voltage</b>	120/208 ÷ 144/250 V
<b>IP degree of protection</b>	IP44

**Further technical details**

<b>Weight</b>	442,00 g
<b>Operating temperature range (min, max)</b>	-25°C ... +40°C
<b>IK rating (impact degree of protection)</b>	IK08

**Material properties**

<b>Colour</b>	RAL 7035 grey, RAL 5015 blue
<b>RoHs conformity</b>	Compliant with exemption 6(c): copper alloy containing up to 4% lead by weight
<b>China RoHs - EFUP</b>	50
<b>REACH SVHC substances</b>	Yes Lead
<b>SCIP number</b>	Ce861c8d-b979-403b-96d9-80aef6dc281d

**Approvals / Standards**

<b>Reference standard</b>	EN 60309-1, -2 e -4
---------------------------	---------------------

**General ordering information**

<b>EAN13 code</b>	8015747084536
-------------------	---------------

**Packaging Information**

<b>Sub-packaging length</b>	116,00 mm
<b>Sub-packaging height</b>	113,00 mm
<b>Sub-packaging width</b>	142,00 mm
<b>Sub-packaging weight</b>	0,44 kg
<b>Sub-packaging volume</b>	1,86 dm <sup>3</sup>
<b>Sub-packaging description</b>	Carton box
<b>Sub-packaging quantity</b>	1 Pcs
<b>Sub-packaging EAN barcode</b>	8015747084543

Part number

# SQ 1695



## Catalogue drawings

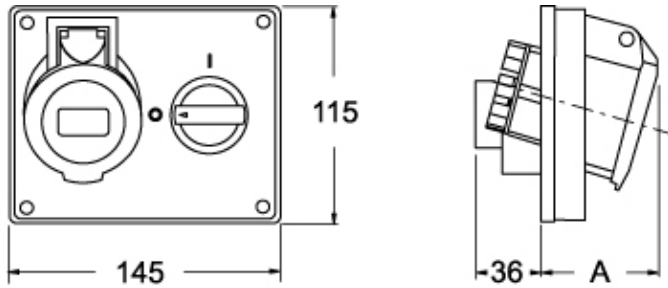

SQ		A
16A	2P+⊕	59
	3P+⊕	63
	3P+N+⊕	63

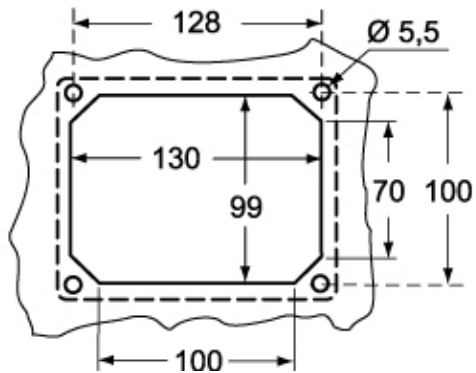

## Notes

Dimensions shown in mm are not binding and may be changed without notice.