

Part number

# SQ 1634



Interlocked switched socket-outlet, SQ series,  
3 poles + PE, 3 h (red), 16 A, 380 ÷ 380 V,  
without fuse-carrier

#### Product description

<b>Product type</b>	Interlocked switched socket-outlet
<b>Series</b>	SQ
<b>N. of poles</b>	3 poles + 
<b>Clock position</b>	3
<b>Specification</b>	Without fuse-carrier

#### Technical data

<b>Current</b>	16 A
<b>Voltage</b>	380V (50Hz.) 440V (60Hz.)
<b>IP degree of protection</b>	IP44

#### Further technical details

<b>Operating temperature range (min, max)</b>	-25°C ... +40°C
<b>IK rating (impact degree of protection)</b>	IK08

#### Material properties

<b>Colour</b>	RAL 7035 grey, RAL 3000 red
---------------	-----------------------------

#### Approvals / Standards

<b>Reference standard</b>	EN 60309-1, -2 e -4
---------------------------	---------------------

#### General ordering information

<b>EAN13 code</b>	8015747159319
-------------------	---------------

Part number

# SQ 1634



## Catalogue drawings

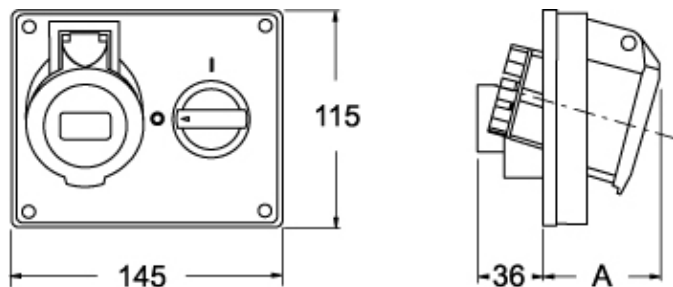

SQ		A
16A	2P+⊕	59
	3P+⊕	63
	3P+N+⊕	63

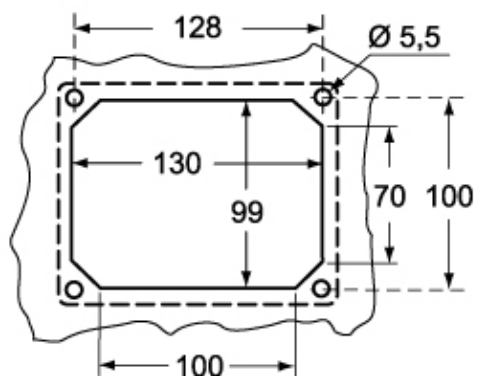

## Notes

Dimensions shown in mm are not binding and may be changed without notice.