

Part number

PK 6395 EB



Interlocked switched socket-outlet, PK series,
3 poles + N + PE, 9 h (blue), 63 A, 208 ÷ 250
V, without fuse-carrier

Product description		Material properties	
Product type	Interlocked switched socket-outlet	Colour	RAL 7035 grey, RAL 5015 blue
Series	PK..EB		Compliant with exemption 6(c): copper alloy containing up to 4% lead by weight
N. of poles	3 poles + N + 	RoHs conformity	6(c): copper alloy containing up to 4% lead by weight
Clock position	9	China RoHs - EFUP	50
Size	114x228 fixing plates FC xx41 TB	REACH SVHC substances	Yes Lead
Cable entry	Pg29	SCIP number	F6799547-ab84-42f2-938f-233ba663766d
Specification	Without fuse-carrier	Approvals / Standards	
Technical data		Reference standard	EN 60309-1, -2 e -4
Current	63 A	General ordering information	
Voltage	208 - 250 V	EAN13 code	8015747083041
IP degree of protection	IP44	Packaging Information	
Further technical details		Sub-packaging length	290,00 mm
Weight	1.850,00 g	Sub-packaging height	125,00 mm
Operating temperature range (min, max)	-25°C ... +40°C	Sub-packaging width	155,00 mm
IK rating (impact degree of protection)	IK10	Sub-packaging weight	1,85 kg
		Sub-packaging volume	5,62 dm ³
		Sub-packaging description	Carton box
		Sub-packaging quantity	1 Pcs
		Sub-packaging EAN barcode	8015747083058

Part number

PK 6395 EB



Catalogue drawings

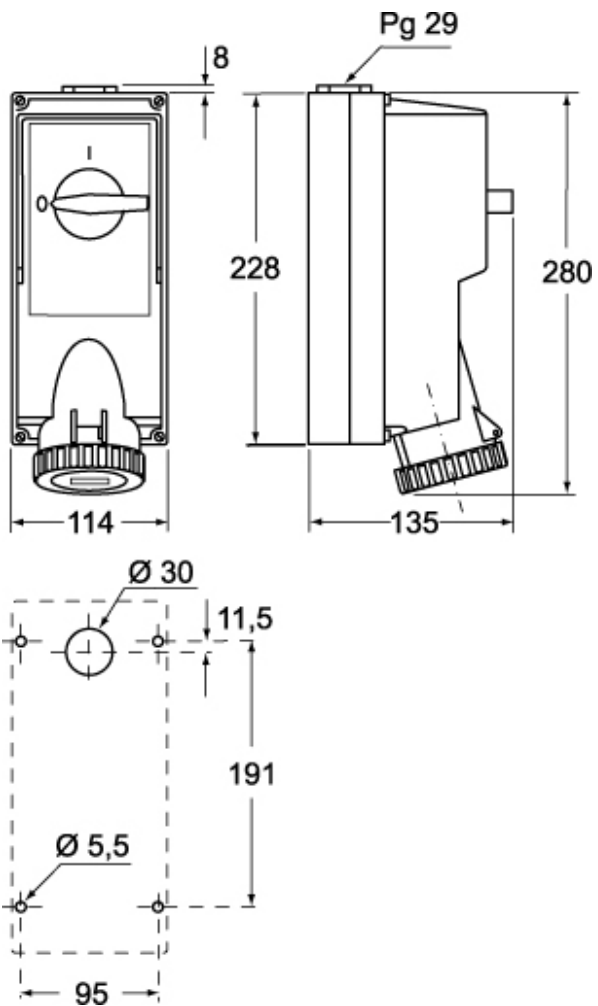

Notes

Dimensions shown in mm are not binding and may be changed without notice.