

Part number

# PK 6363 EB



Interlocked switched socket-outlet, PK series,  
2 poles + PE, 6 h (blue), 63 A, 200 ÷ 250 V,  
without fuse-carrier

#### Product description

|                       |   |
|-----------------------|---|
| <b>Product type</b>   | Interlocked switched socket-outlet  |
| <b>Series</b>         | PK..EB  |
| <b>N. of poles</b>    | 2 poles +  |
| <b>Clock position</b> | 6   |
| <b>Size</b>           | 114x228 fixing plates FC xx41 TB  |
| <b>Cable entry</b>    | Pg29  |
| <b>Specification</b>  | Without fuse-carrier  |

#### Technical data

|  |                 |
|--|-----------------|
| <b>Current</b>                                 | 63 A            |
| <b>Voltage</b>                                 | 200 ÷ 250 V     |
| <b>IP degree of protection</b>                 | IP44            |
| <b>Further technical details</b>               |                 |
| <b>Weight</b>                                  | 1.704,00 g      |
| <b>Operating temperature range (min, max)</b>  | -25°C ... +40°C |
| <b>IK rating (impact degree of protection)</b> | IK10            |

#### Material properties

|                              |  |
|------------------------------|--|
| <b>Colour</b>                | RAL 7035 grey, RAL 5015 blue   |
| <b>RoHs conformity</b>       | Compliant with exemption 6(c): copper alloy containing up to 4% lead by weight |
| <b>China RoHs - EFUP</b>     | 50   |
| <b>REACH SVHC substances</b> | Yes<br>Lead  |
| <b>SCIP number</b>           | F6799547-ab84-42f2-938f-233ba663766d   |

#### Approvals / Standards

|                           |                     |
|---------------------------|---------------------|
| <b>Reference standard</b> | EN 60309-1, -2 e -4 |
|---------------------------|---------------------|

#### General ordering information

|                   |               |
|-------------------|---------------|
| <b>EAN13 code</b> | 8015747082402 |
|-------------------|---------------|

#### Packaging Information

|                                  |                       |
|----------------------------------|-----------------------|
| <b>Packaging length</b>          | 535,00 mm             |
| <b>Packaging height</b>          | 320,00 mm             |
| <b>Packaging width</b>           | 325,00 mm             |
| <b>Packaging weight</b>          | 15,10 kg              |
| <b>Packaging volume</b>          | 55,64 dm <sup>3</sup> |
| <b>Packaging description</b>     | Carton box            |
| <b>Packaging quantity</b>        | 8 Pcs                 |
| <b>Packaging EAN code</b>        | 8015747082419         |
| <b>Sub-packaging length</b>      | 290,00 mm             |
| <b>Sub-packaging height</b>      | 125,00 mm             |
| <b>Sub-packaging width</b>       | 155,00 mm             |
| <b>Sub-packaging weight</b>      | 1,89 kg               |
| <b>Sub-packaging volume</b>      | 5,62 dm <sup>3</sup>  |
| <b>Sub-packaging description</b> | Carton box            |
| <b>Sub-packaging quantity</b>    | 1 Pcs                 |
| <b>Sub-packaging EAN barcode</b> | 8015747082426         |

Part number

# PK 6363 EB



## Catalogue drawings

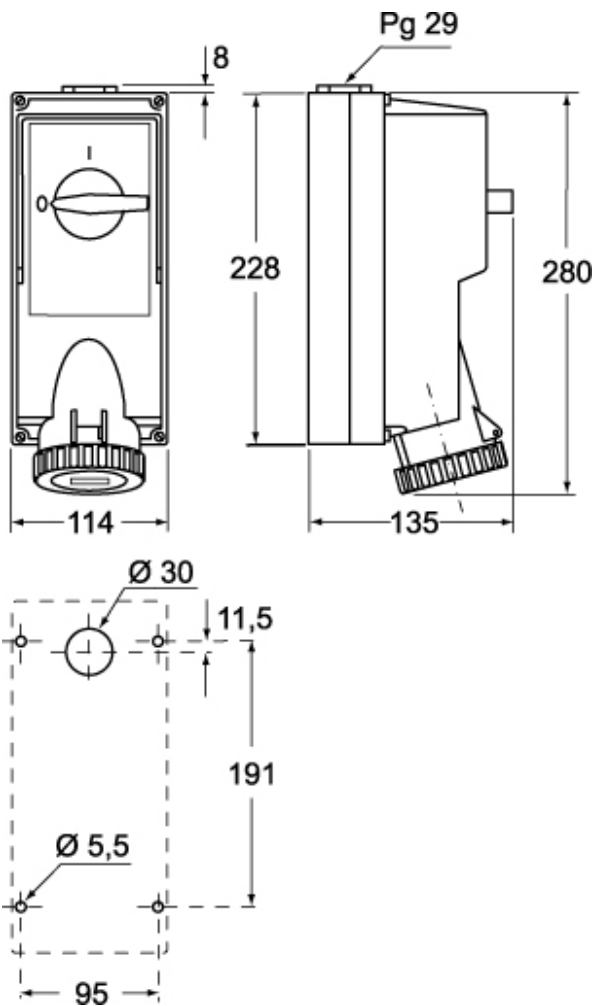

## Notes

Dimensions shown in mm are not binding and may be changed without notice.