

Part number

PK 1635 EB



Interlocked switched socket-outlet, PK series,
3 poles + N + PE, 3 h (red), 16 A, 220/380 V,
without fuse-carrier

Product description

Product type	Interlocked switched socket-outlet
Series	PK..EB
N. of poles	3 poles + N + 
Clock position	3
Specification	Without fuse-carrier

Technical data

Current	16 A
Voltage	220/380V (50Hz) 250/440V (60Hz)
IP degree of protection	IP44

Further technical details

Operating temperature range (min, max)	-25°C ... +40°C
IK rating (impact degree of protection)	IK10

Material properties

Colour	RAL 7035 grey, RAL 3000 red
---------------	-----------------------------

Approvals / Standards

Reference standard	EN 60309-1, -2 e -4
---------------------------	---------------------

General ordering information

EAN13 code	8015747158794
-------------------	---------------

Part number

PK 1635 EB



Catalogue drawings

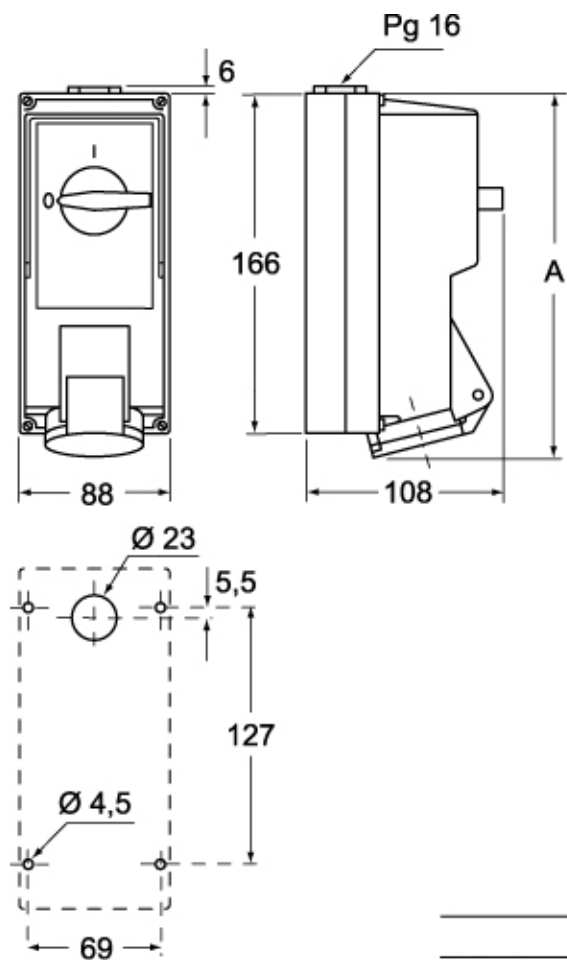

	A
2P+⊕	182
3P+⊕	182
3P+N+⊕	187

Notes

Dimensions shown in mm are not binding and may be changed without notice.