

Part number

PHW 12564 SV



Mobile plug, PLUSO HEAVY DUTY series, 3 poles + PE, 6 h (red), 125 A, 380 ÷ 415 V, straight

Product description

| | |
|-----------------------|---|
| Product type | Plug Mobile |
| Series | PHW...SV, PLUSO HEAVY DUTY |
| N. of poles | 3 poles +  |
| Clock position | 6 |
| Specification | Straight |

Technical data

| | |
|--------------------------------|-------------|
| Current | 125 A |
| Voltage | 380 ÷ 415 V |
| IP degree of protection | IP66 / IP67 |

Further technical details

| | |
|---|------------------|
| Weight | 1.690,00 g |
| Operating temperature range (min, max) | -40°C ... +100°C |

Material properties

| | |
|------------------------------|--|
| Colour | RAL 7012 grey, RAL 3000 red |
| RoHs conformity | Compliant with exemption 6(c): copper alloy containing up to 4% lead by weight |
| China RoHs - EFUP | 50 |
| REACH SVHC substances | Yes Lead |
| SCIP number | Ca7de37f-add8-4b77-9861-279c94903ade |

Approvals / Standards

| | |
|---------------------------|-------------------|
| Reference standard | EN 60309-1 and -2 |
|---------------------------|-------------------|

General ordering information

| | |
|-------------------|---------------|
| EAN13 code | 8015747144544 |
|-------------------|---------------|

Packaging Information

| | |
|----------------------------------|-----------------------|
| Packaging length | 330,00 mm |
| Packaging height | 170,00 mm |
| Packaging width | 230,00 mm |
| Packaging weight | 3,63 kg |
| Packaging volume | 12,90 dm ³ |
| Packaging description | Carton box |
| Packaging quantity | 2 Pcs |
| Packaging EAN code | 8015747226356 |
| Sub-packaging weight | 1,82 kg |
| Sub-packaging description | Carton box |
| Sub-packaging quantity | 1 Pcs |
| Sub-packaging EAN barcode | 8015747144711 |

Part number

PHW 12564 SV



Catalogue drawings

(63 / 125A) PHW ... SV

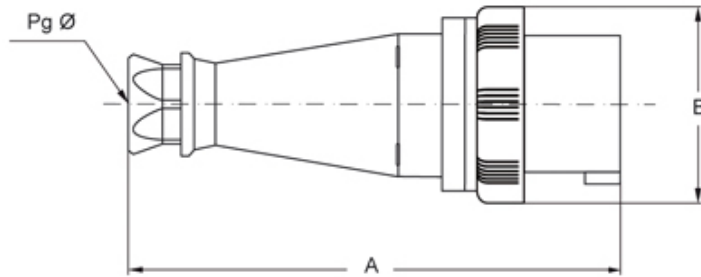

| PHW...SV | | A | B | Pg ø |
|----------|--------|-------|-----|-------|
| 63A | 2P+⊕ | 264,5 | 112 | 36 |
| | 3P+⊕ | 264,5 | 112 | 36 |
| | 3P+N+⊕ | 264,5 | 112 | 36 |
| 125A | 2P+⊕ | 310 | 130 | 2"gas |
| | 3P+⊕ | 310 | 130 | 2"gas |
| | 3P+N+⊕ | 310 | 130 | 2"gas |

Notes

Dimensions shown in mm are not binding and may be changed without notice.

-
- Temperature range: from -40 °C to +100 °C
 - Compliant with EN 60309-1 and -2
 - Enclosure, insert and locking ring in insulating, thermoplastic, self-extinguishing material
 - PHW...SV types (IP66/IP67), entry with cable gland colour coded according to the operating voltage, RAL 9005 black enclosure, locking ring with gasket colour coded according to the operating voltage
 - Terminals with retained screws
 - Stainless steel insert fixing screws
 - Nickel-plated contacts as standard
-