

Part number

# PEW 63123 PQ



Flush-mounting socket outlet, PLUSO series, 2 poles + PE, 12 h (white), 63 A, straight

#### Product description

<b>Product type</b>	Socket Flush-mounting
<b>Series</b>	PEW...PQ, PLUSO
<b>N. of poles</b>	2 poles + 
<b>Clock position</b>	12
<b>Specification</b>	Straight

#### Technical data

<b>Current</b>	63 A
<b>Voltage</b>	ins. transformer
<b>IP degree of protection</b>	IP67

#### Further technical details

<b>Operating temperature range (min, max)</b>	-25°C ... +40°C
---	-----------------

#### Material properties

<b>Colour</b>	RAL 7035 grey, RAL 9010 white
---------------	-------------------------------

#### Approvals / Standards

<b>Reference standard</b>	EN 60309-1 and -2
---------------------------	-------------------

#### General ordering information

<b>EAN13 code</b>	8015747158220
-------------------	---------------

Part number

# PEW 63123 PQ



Catalogue drawings

(63 / 125A) PEW ... PQ

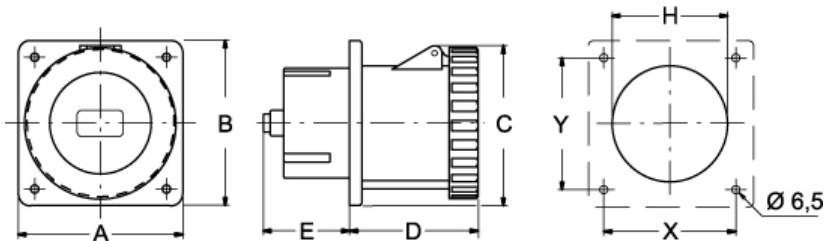

PEW ... PQ	A	B	C	D	E	H	X	Y
<b>63A</b> 2P+⊕	100	107	109	92	30	73	77	85
	100	107	109	92	30	73	77	85
	100	107	109	92	30	73	77	85
<b>125A</b> 2P+⊕	130	130	130	101	68	91	104	104
	130	130	130	101	68	91	104	104
	130	130	130	101	68	91	104	104

## Notes

Dimensions shown in mm are not binding and may be changed without notice.

- Compliant with EN 60309-1 and -2
- Enclosure, insert and spring lid in insulating, thermoplastic, self-extinguishing material
- RAL 7035 grey enclosure, spring lid colour coded according to the operating voltage
- Flange with anti-ageing gasket
- PE...PQ types (IP44), spring lid
- PEW...PQ types (IP67), spring lid with locking ring and gasket
- Terminals with retained screws
- 63A, 125A: with pilot contact
- Nickel-plated contacts, available on request for 16A and 32A (standard on 63A and 125A). For the code of products with nickel-plated contacts (socket holes, plug pins), add "N" to the pre-code of the corresponding standard product code; for example: PE becomes PEN and PEW becomes PEWN.
- IP44 and IP67 degrees of protection (EN 60529)