

Part number

# PEW 3235 SI



Flush-mounting plug, PLUSO series, 3 poles + N + PE, 3 h (red), 32 A, 380 V

#### Product description

|                       |   |
|-----------------------|---|
| <b>Product type</b>   | Plug<br>Flush-mounting  |
| <b>Series</b>         | PEW...SI, PLUSO   |
| <b>N. of poles</b>    | 3 poles + N +  |
| <b>Clock position</b> | 3   |

#### Technical data

|                                |                                 |
|--------------------------------|---------------------------------|
| <b>Current</b>                 | 32 A                            |
| <b>Voltage</b>                 | 220/380V (50Hz) 250/440V (60Hz) |
| <b>IP degree of protection</b> | IP67                            |

#### Further technical details

|   |                 |
|---|-----------------|
| <b>Operating temperature range (min, max)</b> | -25°C ... +40°C |
|---|-----------------|

#### Material properties

|               |                             |
|---------------|-----------------------------|
| <b>Colour</b> | RAL 7035 grey, RAL 3000 red |
|---------------|-----------------------------|

#### Approvals / Standards

|                           |                   |
|---------------------------|-------------------|
| <b>Reference standard</b> | EN 60309-1 and -2 |
|---------------------------|-------------------|

#### General ordering information

|                   |               |
|-------------------|---------------|
| <b>EAN13 code</b> | 8015747157865 |
|-------------------|---------------|

Part number

# PEW 3235 SI



Catalogue drawings

(16 / 32A) PEW ... SI

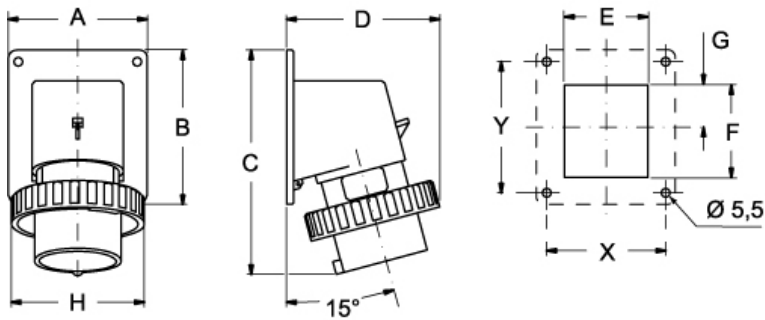

| PEW ... SI      | A  | B   | C   | D   | E  | F  | G    | H   | X  | Y  |
|-----------------|----|-----|-----|-----|----|----|------|-----|----|----|
| <b>16A</b> 2P+⊕ | 65 | 82  | 126 | 81  | 41 | 43 | 21,5 | 70  | 52 | 60 |
| 3P+⊕            | 65 | 82  | 126 | 81  | 47 | 43 | 24,5 | 78  | 52 | 60 |
| 3P+N+⊕          | 90 | 100 | 146 | 93  | 54 | 60 | 27,5 | 86  | 77 | 85 |
| <b>32A</b> 2P+⊕ | 90 | 100 | 160 | 101 | 55 | 60 | 27,5 | 92  | 77 | 85 |
| 3P+⊕            | 90 | 100 | 160 | 101 | 55 | 60 | 27,5 | 92  | 77 | 85 |
| 3P+N+⊕          | 90 | 100 | 160 | 101 | 62 | 60 | 27,5 | 100 | 77 | 85 |

## Notes

Dimensions shown in mm are not binding and may be changed without notice.

- Compliant with EN 60309-1 and -2
- Enclosure, insert and locking ring in insulating, thermoplastic, self-extinguishing material
- Flange with anti-ageing gasket
- PE...SI types (IP44), RAL 7035 grey enclosure, plug mouth colour coded according to the operating voltage
- PEW...SI (IP67) types, RAL 7035 grey enclosure, locking ring with gasket colour coded according to the operating voltage
- Terminals with retained screws
- 63A, 125A: with pilot contact
- Nickel-plated contacts, available on request for 16A and 32A (standard on 63A and 125A). For the code of products with nickel-plated contacts (socket holes, plug pins), add "N" to the pre-code of the corresponding standard product code; for example: PE becomes PEN and PEW becomes PEWN.
- IP44 and IP67 degrees of protection (EN 60529)