

Part number

PEW 1643 PQ



Flush-mounting socket outlet, PLUSO series, 2 poles + PE, 4 h (yellow), 16 A, 100 ÷ 130 V, straight

Product description

| | |
|-----------------------|---|
| Product type | Socket Flush-mounting |
| Series | PEW...PQ, PLUSO |
| N. of poles | 2 poles +  |
| Clock position | 4 |
| Size | Socket fixing centre distance 52 x 52 mm |
| Specification | Straight |

Technical data

| | |
|---|-----------------|
| Current | 16 A |
| Voltage | 100 ÷ 130 V |
| IP degree of protection | IP67 |
| Further technical details | |
| Weight | 141,00 g |
| Operating temperature range (min, max) | -25°C ... +40°C |

Material properties

| | |
|------------------------------|--|
| Colour | RAL 7035 grey, RAL 1021 yellow |
| RoHs conformity | Compliant with exemption 6(c): copper alloy containing up to 4% lead by weight |
| China RoHs - EFUP | 50 |
| REACH SVHC substances | Yes Lead |
| SCIP number | Ca7de37f-add8-4b77-9861-279c94903ade |

Approvals / Standards

| | |
|---------------------------|-------------------|
| Reference standard | EN 60309-1 and -2 |
|---------------------------|-------------------|

General ordering information

| | |
|-------------------|---------------|
| EAN13 code | 8015747071970 |
|-------------------|---------------|

Packaging Information

| | |
|------------------------------|----------------------|
| Packaging length | 285,00 mm |
| Packaging height | 170,00 mm |
| Packaging width | 190,00 mm |
| Packaging weight | 1,60 kg |
| Packaging volume | 9,21 dm ³ |
| Packaging description | Carton box |
| Packaging quantity | 10 Pcs |
| Packaging EAN code | 8015747071987 |

Part number

PEW 1643 PQ



Catalogue drawings

(16 / 32A) PEW ... PQ

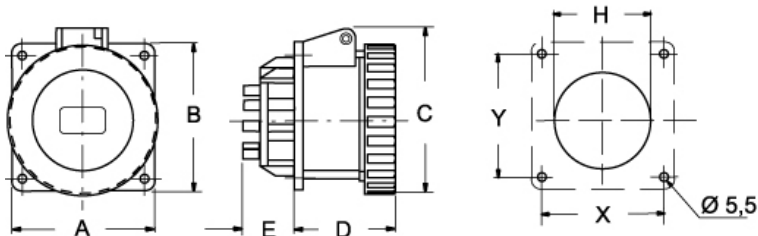

| PEW ... PQ | A | B | C | D | E | H | X | Y | |
|------------|--------|----|----|-----|----|----|------|----|----|
| 16A | 2P+⊕ | 65 | 65 | 77 | 52 | 27 | 60 | 52 | 52 |
| | 3P+⊕ | 65 | 65 | 85 | 52 | 27 | 61,5 | 52 | 52 |
| | 3P+N+⊕ | 80 | 80 | 93 | 52 | 27 | 70 | 60 | 60 |
| 32A | 2P+⊕ | 80 | 80 | 98 | 62 | 28 | 68 | 60 | 60 |
| | 3P+⊕ | 80 | 80 | 98 | 62 | 28 | 68 | 60 | 60 |
| | 3P+N+⊕ | 80 | 80 | 105 | 62 | 28 | 73 | 60 | 60 |

Notes

Dimensions shown in mm are not binding and may be changed without notice.

- Compliant with EN 60309-1 and -2
- Enclosure, insert and spring lid in insulating, thermoplastic, self-extinguishing material
- RAL 7035 grey enclosure, spring lid colour coded according to the operating voltage
- Flange with anti-ageing gasket
- PE...PQ types (IP44), spring lid
- PEW...PQ types (IP67), spring lid with locking ring and gasket
- Terminals with retained screws
- 63A, 125A: with pilot contact
- Nickel-plated contacts, available on request for 16A and 32A (standard on 63A and 125A). For the code of products with nickel-plated contacts (socket holes, plug pins), add "N" to the pre-code of the corresponding standard product code; for example: PE becomes PEN and PEW becomes PEWN.
- IP44 and IP67 degrees of protection (EN 60529)