

Part number

PE 3235 PQ



Flush-mounting socket outlet, PLUSO series, 3 poles + N + PE, 3 h (red), 32 A, 380 V, straight

Product description

Product type	Socket Flush-mounting
Series	PE...PQ, PLUSO
N. of poles	3 poles + N + 
Clock position	3
Specification	Straight

Technical data

Current	32 A
Voltage	220/380V (50Hz) 250/440V (60Hz)
IP degree of protection	IP44

Further technical details

Operating temperature range (min, max)	-25°C ... +40°C
---	-----------------

Material properties

Colour	RAL 7035 grey, RAL 3000 red
---------------	-----------------------------

Approvals / Standards

Reference standard	EN 60309-1 and -2
---------------------------	-------------------

General ordering information

EAN13 code	8015747155533
-------------------	---------------

Part number

PE 3235 PQ



Catalogue drawings

(16 / 32A) PE ... PQ

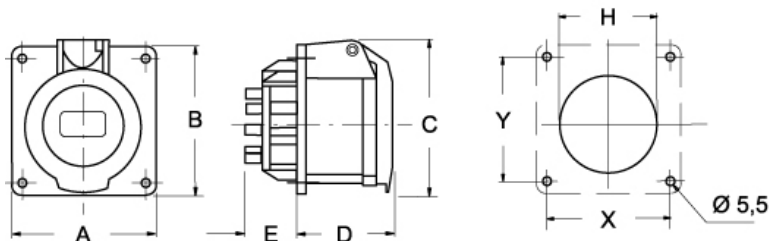

PE ... PQ	A	B	C	D	E	H	X	Y
16A 2P+⊕	65	65	71	52	27	60	52	52
	65	65	75	53	27	61,5	52	52
	80	80	86	53	27	70	60	60
32A 2P+⊕	80	80	87	62	28	68	60	60
	80	80	87	62	28	68	60	60
	80	80	92	62	28	73	60	60

Notes

Dimensions shown in mm are not binding and may be changed without notice.

- Compliant with EN 60309-1 and -2
- Enclosure, insert and spring lid in insulating, thermoplastic, self-extinguishing material
- RAL 7035 grey enclosure, spring lid colour coded according to the operating voltage
- Flange with anti-ageing gasket
- PE...PQ types (IP44), spring lid
- PEW...PQ types (IP67), spring lid with locking ring and gasket
- Terminals with retained screws
- 63A, 125A: with pilot contact
- Nickel-plated contacts, available on request for 16A and 32A (standard on 63A and 125A). For the code of products with nickel-plated contacts (socket holes, plug pins), add "N" to the pre-code of the corresponding standard product code; for example: PE becomes PEN and PEW becomes PEWN.
- IP44 and IP67 degrees of protection (EN 60529)