

Part number

# PE 1643 SM



Wall-mounting plug, PLUSO series, 2 poles + PE, 4 h (yellow), 16 A, 100 ÷ 130 V

#### Product description

<b>Product type</b>	Plug Wall-mounting
<b>Series</b>	PE...SM, PLUSO
<b>N. of poles</b>	2 poles +
<b>Clock position</b>	4

#### Technical data

<b>Current</b>	16 A
<b>Voltage</b>	100 ÷ 130 V
<b>IP degree of protection</b>	IP44

#### Further technical details

<b>Weight</b>	139,50 g
<b>Operating temperature range (min, max)</b>	-25°C ... +40°C

#### Material properties

<b>Colour</b>	RAL 7035 grey, RAL 1021 yellow
<b>RoHs conformity</b>	Compliant with exemption 6(c): copper alloy containing up to 4% lead by weight
<b>China RoHs - EFUP</b>	50
<b>REACH SVHC substances</b>	Yes Lead
<b>SCIP number</b>	Ca7de37f-add8-4b77-9861-279c94903ade

#### Approvals / Standards

<b>Reference standard</b>	EN 60309-1 and -2
---------------------------	-------------------

#### General ordering information

<b>EAN13 code</b>	8015747063876
-------------------	---------------

#### Packaging Information

<b>Packaging length</b>	208,00 mm
<b>Packaging height</b>	140,00 mm
<b>Packaging width</b>	290,00 mm
<b>Packaging weight</b>	1,62 kg
<b>Packaging volume</b>	8,44 dm <sup>3</sup>
<b>Packaging description</b>	Carton box
<b>Packaging quantity</b>	10 Pcs
<b>Packaging EAN code</b>	8015747063883

Part number

# PE 1643 SM



Catalogue drawings

(16 / 32A) PE ... SM

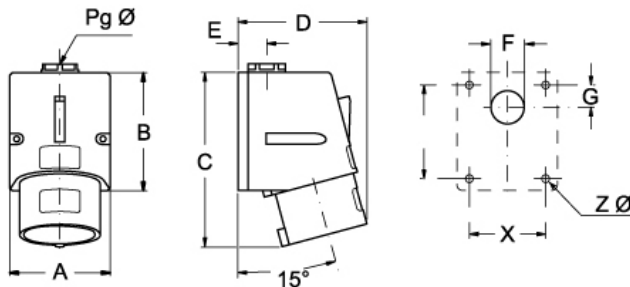

PE ... SM	A	B	C	D	E	F	G	X	Y	Z Ø	Pg Ø	
<b>16A</b>	2P+⊕	70	82	115	75	20	23	16	53	65	4,5	16
	3P+⊕	70	82	117	75	20	23	16	53	65	4,5	16
	3P+N+⊕	70	82	121	90	20	23	16	53	65	4,5	16
<b>32A</b>	2P+⊕	86	104	145	95	24	29	17	61	79	6,5	21
	3P+⊕	86	104	145	95	24	29	17	61	79	6,5	21
	3P+N+⊕	86	104	147	95	24	29	17	61	79	6,5	21

## Notes

Dimensions shown in mm are not binding and may be changed without notice.

- Compliant with EN 60309-1 and -2
- Enclosure, insert and locking ring in insulating, thermoplastic, self-extinguishing material
- PE...SM types (IP44), enclosure colour coded according to the operating voltage, top entry with threaded grommet (replaceable with cable gland)
- PEW...SM types (IP67), RAL 7035 grey enclosure, locking ring with gasket colour coded according to the operating voltage, top entry with cable gland
- Terminals with retained screws
- 63A, 125A: with pilot contact
- Nickel-plated contacts, available on request for 16A and 32A (standard on 63A and 125A). For the code of products with nickel-plated contacts (socket holes, plug pins), add "N" to the pre-code of the corresponding standard product code; for example: PE becomes PEN and PEW becomes PEWN.
- 125A: with terminal block for the anchoring of incoming cables, already connected to socket
- IP44 and IP67 degrees of protection (EN 6052)