

Part number

PE 16115 SM



Wall-mounting plug, PLUSO series, 3 poles + N + PE, 11 h (red), 16 A, 250/440 ÷ 265/460 V

Product description

| | |
|-----------------------|---|
| Product type | Plug Wall-mounting |
| Series | PE...SM, PLUSO |
| N. of poles | 3 poles + N +  |
| Clock position | 11 |

Technical data

| | |
|--------------------------------|---------------------|
| Current | 16 A |
| Voltage | 250/440V ÷ 265/460V |
| IP degree of protection | IP44 |

Further technical details

| | |
|---|-----------------|
| Operating temperature range (min, max) | -25°C ... +40°C |
|---|-----------------|

Material properties

| | |
|---------------|-----------------------------|
| Colour | RAL 7035 grey, RAL 3000 red |
|---------------|-----------------------------|

Approvals / Standards

| | |
|---------------------------|-------------------|
| Reference standard | EN 60309-1 and -2 |
|---------------------------|-------------------|

General ordering information

| | |
|-------------------|---------------|
| EAN13 code | 8015747154550 |
|-------------------|---------------|

Part number

PE 16115 SM



Catalogue drawings

(16 / 32A) PE ... SM

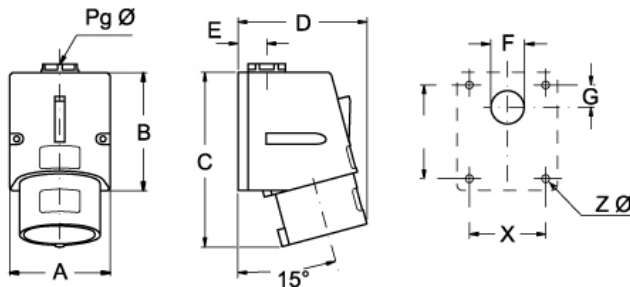

| PE ... SM | A | B | C | D | E | F | G | X | Y | Z Ø | Pg Ø | |
|------------|--------|----|-----|-----|----|----|----|----|----|-----|------|----|
| 16A | 2P+⊕ | 70 | 82 | 115 | 75 | 20 | 23 | 16 | 53 | 65 | 4,5 | 16 |
| | 3P+⊕ | 70 | 82 | 117 | 75 | 20 | 23 | 16 | 53 | 65 | 4,5 | 16 |
| | 3P+N+⊕ | 70 | 82 | 121 | 90 | 20 | 23 | 16 | 53 | 65 | 4,5 | 16 |
| 32A | 2P+⊕ | 86 | 104 | 145 | 95 | 24 | 29 | 17 | 61 | 79 | 6,5 | 21 |
| | 3P+⊕ | 86 | 104 | 145 | 95 | 24 | 29 | 17 | 61 | 79 | 6,5 | 21 |
| | 3P+N+⊕ | 86 | 104 | 147 | 95 | 24 | 29 | 17 | 61 | 79 | 6,5 | 21 |

Notes

Dimensions shown in mm are not binding and may be changed without notice.

- Compliant with EN 60309-1 and -2
- Enclosure, insert and locking ring in insulating, thermoplastic, self-extinguishing material
- PE...SM types (IP44), enclosure colour coded according to the operating voltage, top entry with threaded grommet (replaceable with cable gland)
- PEW...SM types (IP67), RAL 7035 grey enclosure, locking ring with gasket colour coded according to the operating voltage, top entry with cable gland
- Terminals with retained screws
- 63A, 125A: with pilot contact
- Nickel-plated contacts, available on request for 16A and 32A (standard on 63A and 125A). For the code of products with nickel-plated contacts (socket holes, plug pins), add "N" to the pre-code of the corresponding standard product code; for example: PE becomes PEN and PEW becomes PEWN.
- 125A: with terminal block for the anchoring of incoming cables, already connected to socket
- IP44 and IP67 degrees of protection (EN 6052)