

Part number

MVI 10 LAP32



Angled Bulkhead mounting housing, V-TYPE series, with 1 lever, M32 cable entry, size "57.27"

Product description

Product type	Angled bulkhead mounting housing
Series	V-TYPE
Closing type	With 1 lever
Size	Size 57.27
Cable entry	With cable entry M32

Technical data

IP degree of protection IP65 / IP66 / IP69

Further technical details

Weight	303,60 g
Operating temperature range (min, max)	-40°C...+125°C

Material properties

Other materials	Lever: Stainless steel Gasket: NBR
Colour	RAL 7040 grey
RoHs conformity	Compliant
China RoHs - EFUP	E
REACH SVHC substances	No

Approvals / Standards

Certifications	DNV, BV
UL	ECBT2
cUL	ECBT8

General ordering information

EAN13 code	8015747191951
eCl@ss 8.1	27440202
ETIM 7.0	EC000437

Packaging Information

Packaging length	260,00 mm
Packaging height	120,00 mm
Packaging width	140,00 mm
Packaging weight	1,64 kg
Packaging volume	4,37 dm ³
Packaging description	Carton box
Packaging quantity	5 Pcs
Packaging EAN code	8015747191999
Sub-packaging weight	0,33 kg
Sub-packaging description	Plastic packaging
Sub-packaging quantity	1 Pcs
Sub-packaging EAN barcode	8015747192002

Part number

MVI 10 LAP32



Catalogue drawings

MVI 10 LAP32

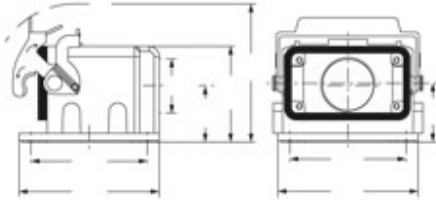

Notes

MVI 10 LAP32

Be used only with a complete cable gland (to be purchased separately).

Versions with M25 or Pg 21 entry on request.

Dimensions shown in mm are not binding and may be changed without notice.
