

Part number

# MMFV 06 LG32



Hood, 830V series, with 1 lever, M32 top cable entry without adapter, size "77.27", high construction

## Product description

<b>Product type</b>	Hood
<b>Series</b>	830V
<b>Closing type</b>	With 1 lever
<b>Size</b>	Size 77.27
<b>Cable entry</b>	Top cable entry M32
<b>Specification</b>	High construction

## Technical data

**IP degree of protection** IP65 / IP66 / IP69

## Further technical details

**Operating temperature range (min, max)** -40°C...+125°C

## Material properties

<b>Colour</b>	RAL 7040 grey
<b>RoHs conformity</b>	Compliant
<b>China RoHs - EFUP</b>	E
<b>REACH SVHC substances</b>	No

## Approvals / Standards

<b>Certifications</b>	DNV, BV
<b>UL</b>	ECBT2
<b>cUL</b>	ECBT8

## General ordering information

**EAN13 code** 8015747152983

Part number

# MMFV 06 LG32



## Catalogue drawings

**CMO L (CMAO L) - MMO L [MMAO L]**

**CMV L [CMAV L] - MMV L (MMAV L)**

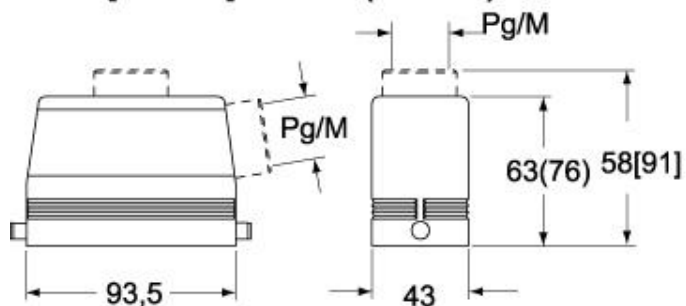

**CMV LG (CMAV LG) - MMV LG (MMAV LG)**

**[MMFV LG]**

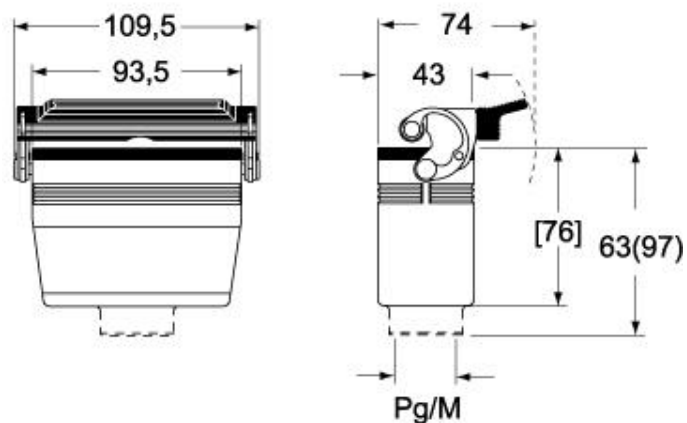

## Notes

Dimensions shown in mm are not binding and may be changed without notice.