

Part number

MMAV 16 G32



Hood, 830V series, with 2 levers, M32 top cable entry, size "104.27", high construction

Product description

| | |
|----------------------|------------------------|
| Product type | Hood |
| Series | 830V |
| Closing type | With 2 levers |
| Size | Size 104.27 |
| Cable entry | Top cable entry M32 |
| Specification | High construction |

Technical data

IP degree of protection IP65 / IP66 / IP69

Further technical details

| | |
|---|----------------|
| Weight | 401,00 g |
| Operating temperature range (min, max) | -40°C...+125°C |

Material properties

| | |
|------------------------------|---------------|
| Colour | RAL 7040 grey |
| RoHs conformity | Compliant |
| China RoHs - EFUP | E |
| REACH SVHC substances | No |

Approvals / Standards

| | |
|-----------------------|---------|
| Certifications | DNV, BV |
| UL | ECBT2 |
| cUL | ECBT8 |

General ordering information

EAN13 code 8015747058117

Packaging Information

| | |
|----------------------------------|-------------------|
| Sub-packaging weight | 2,01 kg |
| Sub-packaging description | Plastic packaging |
| Sub-packaging quantity | 5 Pcs |
| Sub-packaging EAN barcode | 8015747107761 |

Part number

MMAV 16 G32



Catalogue drawings

**CMO [CMAO] CMV (CMAV) - MMO [MMAO]
MMV (MMAV)**

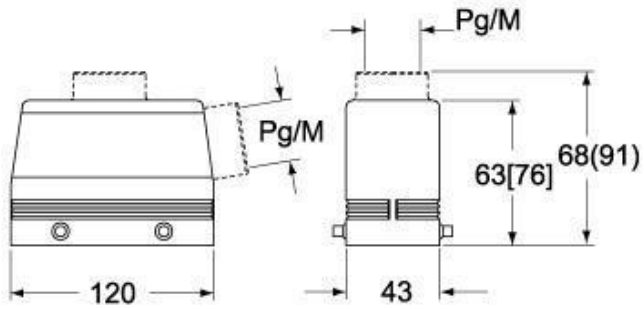

CMV G (CMAV G) - MMV G (MMAV G) - [MMFV G]



Notes

Dimensions shown in mm are not binding and may be changed without notice.