

Part number

# MKH IAP25



Angled Bulkhead mounting housing, CKH series, with 1 lever, M25 cable entry, size "21.21", fixing by 4 screws

#### Product description

<b>Product type</b>	Angled bulkhead mounting housing
<b>Series</b>	CKH
<b>Closing type</b>	With 1 lever
<b>Size</b>	Size "21.21"
<b>Cable entry</b>	With cable entry M25
<b>Specification</b>	Fixing by 4 screws

#### Technical data

<b>IP degree of protection</b>	IP44 (IP66/IP67/IP69 with CKRH 65/CKRH 65 D kits)
--------------------------------	---

#### Further technical details

<b>Weight</b>	22,50 g
<b>Operating temperature range (min, max)</b>	-40°C...+70°C

#### Material properties

<b>Main material</b>	Polyamide (PA)
<b>Other materials</b>	Lever: Polypropylene (PP), metal-detectable Gasket: Silicone rubber
<b>Colour</b>	RAL 7012 grey, RAL 5005 blue
<b>RoHs conformity</b>	Compliant
<b>China RoHs - EFUP</b>	E
<b>REACH SVHC substances</b>	No

#### General ordering information

<b>EAN13 code</b>	8015747301749
<b>eCl@ss 8.1</b>	27440202
<b>ETIM 7.0</b>	EC000437

#### Packaging Information

<b>Sub-packaging weight</b>	0,02 kg
<b>Sub-packaging description</b>	Plastic bag
<b>Sub-packaging quantity</b>	1 Pcs
<b>Sub-packaging EAN barcode</b>	8015747301794

Part number

# MKH IAP25



## Catalogue drawings

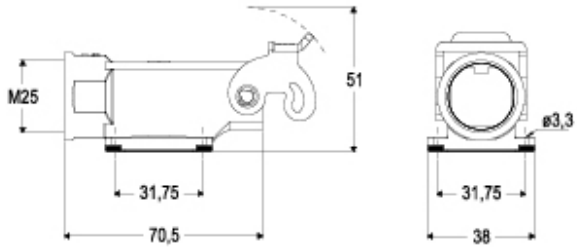

---

## Notes

Dimensions shown in mm are not binding and may be changed without notice.

---