

Part number

# MKAXXS AP25



Angled surface mounting housing, EMC series, with 1 lever, M25 cable entry, size "21.21"

Product description		Material properties	
<b>Product type</b>	Angled surface mounting housing	<b>Main material</b>	Zinc die-cast
<b>Series</b>	EMC	<b>Other materials</b>	Lever: Stainless steel Gasket: Conductive elastomer
<b>Closing type</b>	With 1 lever	<b>Colour</b>	RAL 7040 grey
<b>Size</b>	Size "21.21"	<b>RoHs conformity</b>	Compliant
<b>Cable entry</b>	With cable entry M25	<b>China RoHs - EFUP</b>	E
Technical data		<b>REACH SVHC substances</b>	No
<b>IP degree of protection</b>	IP44 - IP66 / IP67 / IP69 with CKR 65 (D)	Approvals / Standards	
Further technical details		<b>Certifications</b>	DNV, BV
<b>Operating temperature range (min, max)</b>	-40°C...+125°C	<b>UL</b>	ECBT2
		<b>cUL</b>	ECBT8
		General ordering information	
		<b>EAN13 code</b>	8015747259866
		<b>eCl@ss 8.1</b>	27440202
		<b>ETIM 7.0</b>	EC000437

Part number

# MKAXXS AP25



Catalogue drawings

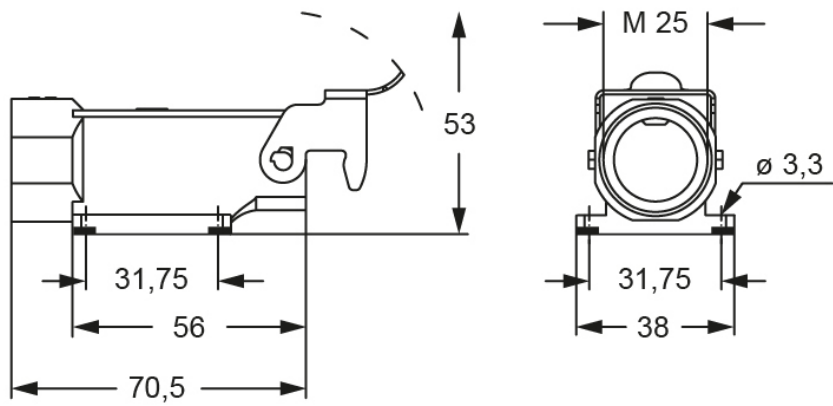

Catalogue drawings

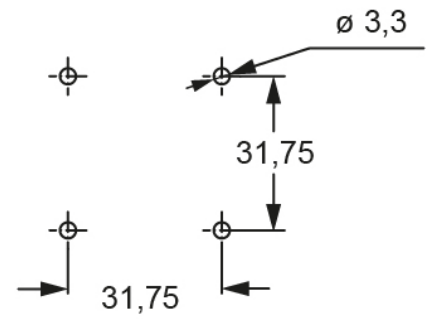

## Notes

Dimensions shown in mm are not binding and may be changed without notice.