

Part number

MKAXW IAP20



Angled Bulkhead mounting housing, W-TYPE series, with 1 lever, M20 cable entry, size "21.21"

Product description		Material properties	
Product type	Angled bulkhead mounting housing	Main material	Zinc die-cast
Series	W-TYPE	Other materials	Lever: Stainless steel Gasket: FKM
Closing type	With 1 lever	Colour	RAL 7040 grey
Size	Size "21.21"	RoHs conformity	Compliant
Cable entry	With cable entry M20	China RoHs - EFUP	E
Technical data		REACH SVHC substances	No
IP degree of protection	IP44 - IP66 / IP67 / IP69 with CKR 65 (D)	Approvals / Standards	
Further technical details		Certifications	DNV, BV
Weight	70,00 g	UL	ECBT2
Operating temperature range (min, max)	-40°C...+125°C	cUL	ECBT8
		General ordering information	
		EAN13 code	8015747129299
		eCl@ss 8.1	27440202
		ETIM 7.0	EC000437
		Packaging Information	
		Sub-packaging length	210,00 mm
		Sub-packaging height	40,00 mm
		Sub-packaging width	175,00 mm
		Sub-packaging weight	0,70 kg
		Sub-packaging volume	1,47 dm ³
		Sub-packaging description	Carton box
		Sub-packaging quantity	10 Pcs
		Sub-packaging EAN barcode	8015747129336

Part number

MKAXW IAP20



Catalogue drawings

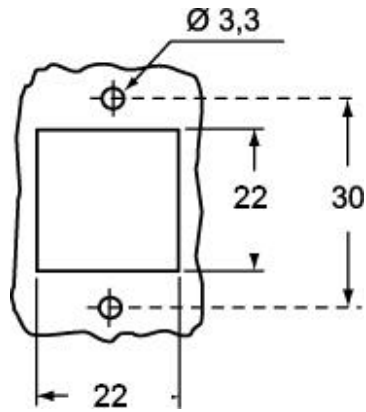

Catalogue drawings

CKAXW I

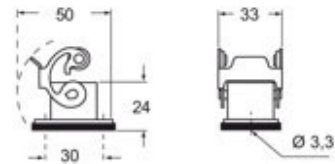

CKAXW IA

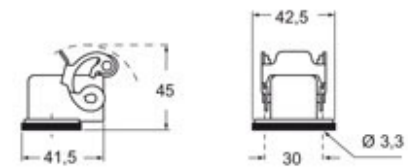

CKAXW IAP (CKAXW AP) MKAXW IAP (MKAXW AP)

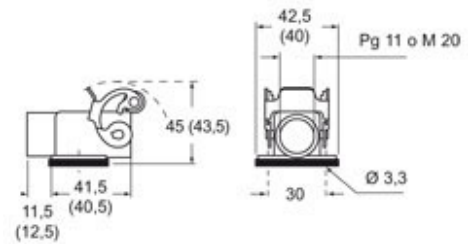

Notes

Dimensions shown in mm are not binding and may be changed without notice.