

Part number

MGP 24.40



Surface mounting housing, IP68 series, for 2 screws, M40 cable entry, size "104.27"

Product description

| | |
|---------------------|--------------------------|
| Product type | Surface mounting housing |
| Series | IP68 |
| Closing type | With 2 screws |
| Size | Size 104.27 |
| Cable entry | With cable entry M40 |

Technical data

IP degree of protection IP66 / IP68 / IP69

Further technical details

| | |
|---|----------------|
| Weight | 1.150,00 g |
| Operating temperature range (min, max) | -40°C...+125°C |

Material properties

| | |
|------------------------------|--------------------|
| Main material | Aluminium die-cast |
| Other materials | Gasket: NBR |
| Colour | RAL 9005 black |
| RoHs conformity | Compliant |
| China RoHs - EFUP | E |
| REACH SVHC substances | No |

Approvals / Standards

| | |
|-----------------------|---------|
| Certifications | DNV, BV |
| UL | ECBT2 |
| cUL | ECBT8 |

General ordering information

| | |
|-------------------|---------------|
| EAN13 code | 8015747125130 |
| eCl@ss 8.1 | 27440202 |
| ETIM 7.0 | EC000437 |

Packaging Information

| | |
|----------------------------------|----------------------|
| Packaging length | 270,00 mm |
| Packaging height | 130,00 mm |
| Packaging width | 135,00 mm |
| Packaging weight | 2,30 kg |
| Packaging volume | 4,74 dm ³ |
| Packaging description | Carton box |
| Packaging quantity | 2 Pcs |
| Packaging EAN code | 8015747125147 |
| Sub-packaging weight | 1,15 kg |
| Sub-packaging description | Plastic packaging |
| Sub-packaging quantity | 1 Pcs |
| Sub-packaging EAN barcode | 8015747125154 |

Part number

MGP 24.40



Catalogue drawings

CGP - MGP

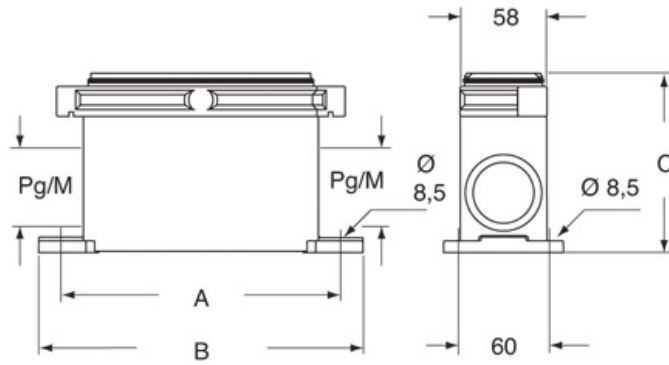

| | A | B | C |
|-----------------|-----|-----|-----|
| CGP 06 - MGP 06 | 127 | 156 | 110 |
| CGP 10 - MGP 10 | 140 | 169 | 110 |
| CGP 16 - MGP 16 | 160 | 189 | 121 |
| CGP 24 - MGP 24 | 187 | 216 | 121 |

Notes

Dimensions shown in mm are not binding and may be changed without notice.