

Part number

MBV 06 L225



Hood, BIG series, with 2 pegs, M25 x 2 double top cable entry, size "44.27"

Product description		Material properties	
Product type	Hood	Other materials	Gasket: NBR
Series	BIG	Colour	RAL 7040 grey
Closing type	With 2 pegs	RoHs conformity	Compliant
Size	Size 44.27	China RoHs - EFUP	E
Cable entry	Double top cable entry M25 x 2	REACH SVHC substances	No
Technical data		Approvals / Standards	
IP degree of protection	IP66	Certifications	DNV, BV
Further technical details		UL	ECBT2
Contact resistance	≤ 3 mΩ	cUL	ECBT8
Weight	400,00 g	General ordering information	
Operating temperature range (min, max)	-40°C...+125°C	EAN13 code	8015747186902
Conductors stripping length	6 - 8 mm	eCl@ss 8.1	27440202
Torque for main contact	M2,5: 0.4 Nm; 3.5 lb.in (0,5 x 3mm)	ETIM 7.0	EC000437
Tightening torque for PE connection	M4: 1,2 Nm, 10,6 lb.in (Ph2 or 1,0x5,5mm)	Packaging Information	
Tightening torque for fixing screws	M3: 0.5 Nm; 4.4 lb.in (Ph1 or 0.8x4 mm)	Packaging length	180,00 mm
		Packaging height	120,00 mm
		Packaging width	155,00 mm
		Packaging weight	1,62 kg
		Packaging volume	3,35 dm ³
		Packaging description	Carton box
		Packaging quantity	4 Pcs
		Packaging EAN code	8015747220781
		Sub-packaging weight	0,41 kg
		Sub-packaging description	Plastic packaging
		Sub-packaging quantity	1 Pcs
		Sub-packaging EAN barcode	8015747035743

Part number

MBV 06 L225



Catalogue drawings

MBV 06 L225

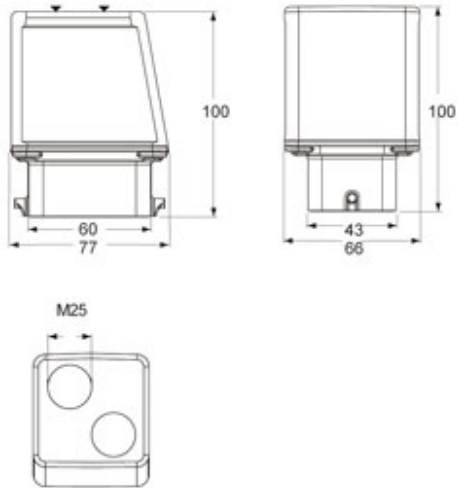

Notes

Dimensions shown in mm are not binding and may be changed without notice.
