

Part number

MAOR 16.40



Hood, 180 °C series, with 4 pegs, M40 side cable entry, size "77.27", high construction

Product description		Material properties	
Product type	Hood	RoHs conformity	Compliant
Series	180 °C	China RoHs - EFUP	E
Closing type	With 4 pegs	REACH SVHC substances	No
Size	Size 77.27	Approvals / Standards	
Cable entry	Side cable entry M40	Certifications	DNV, BV
Specification	High construction	UL	ECBT2
Technical data		cUL	ECBT8
IP degree of protection	IP65	General ordering information	
Further technical details		EAN13 code	8015747151689
Weight	171,00 g	eCl@ss 8.1	27440202
Operating temperature range (min, max)	-40°C ... +180°C	ETIM 7.0	EC000437
		Packaging Information	
		Sub-packaging weight	0,86 kg
		Sub-packaging description	Plastic packaging
		Sub-packaging quantity	5 Pcs
		Sub-packaging EAN barcode	8015747164580

Part number

MAOR 16.40



Catalogue drawings

CHOR (CAOR) - MHOR (MAOR)

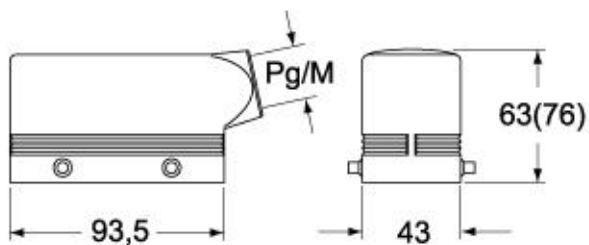

CHVR (CAVR) - MHVR (MAVR)

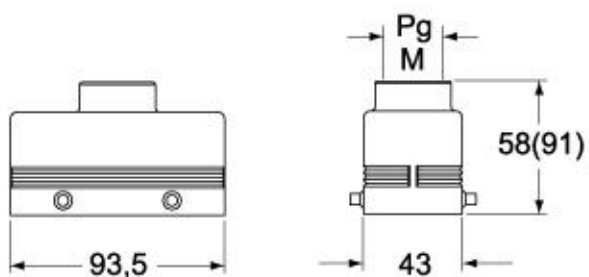

CHCR G

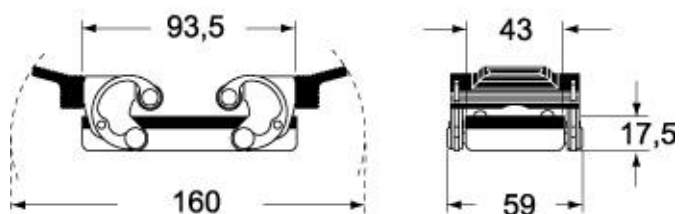

Notes

Dimensions shown in mm are not binding and may be changed without notice.
