

Part number

M7APE 16.240



Surface mounting housing, E-Xtreme® V-TYPE series, with 2 levers, M40 x 2 cable entry, size "77.27", high construction

Product description

Product type	Surface mounting housing
Series	E-Xtreme® V-TYPE
Closing type	With 2 levers
Size	Size 77.27
Cable entry	With cable entry M40 x 2
Specification	High construction

Technical data

IP degree of protection IP66 / IP67 / IP69

Further technical details

Weight	400,00 g
Operating temperature range (min, max)	-40°C...+125°C

Material properties

Other materials	Lever: Stainless steel Gasket: FKM
Colour	RAL 7016 grey
RoHS conformity	Compliant
China RoHS - EFUP	E
REACH SVHC substances	No

Approvals / Standards

Certifications	DNV, BV
UL	ECBT2
cUL	ECBT8

General ordering information

EAN13 code	8015747252638
eCl@ss 8.1	27440202
ETIM 7.0	EC000437

Packaging Information

Packaging length	300,00 mm
Packaging height	160,00 mm
Packaging width	180,00 mm
Packaging weight	4,10 kg
Packaging volume	8,64 dm ³
Packaging description	Carton box
Packaging quantity	10 Pcs
Packaging EAN code	8015747252645
Sub-packaging weight	2,05 kg
Sub-packaging description	Plastic packaging
Sub-packaging quantity	5 Pcs
Sub-packaging EAN barcode	8015747252652

Part number

M7APE 16.240



Catalogue drawings

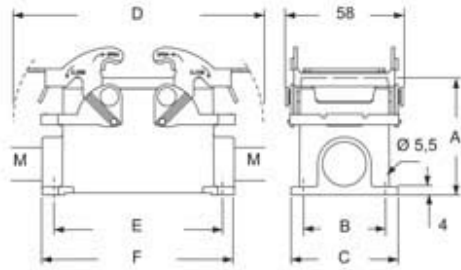

type	A	B	C	D	E	F
M7PE 16	63	45	57	142,5	105	117
M7APE 16	77	45	57	142,5	105	117

Notes

Dimensions shown in mm are not binding and may be changed without notice.
