

Part number

JMPP 24.25



Surface mounting housing, JEI®-P series, with 2 levers, M25 cable entry, size 104.27

Product description		Material properties	
Product type	Surface mounting housing	Other materials	Lever: Polyamide (PA) Gasket: NBR
Series	JEI®-P	Colour	RAL 7040 grey
Closing type	With 2 levers	Approvals / Standards	
Size	Size 104.27	Certifications	DNV, BV
Cable entry	With cable entry M25	UL	ECBT2
Technical data		General ordering information	
IP degree of protection	IP65	EAN13 code	8015747100922
Further technical details		Packaging Information	
Weight	354,00 g	Packaging length	475,00 mm
Operating temperature range (min, max)	-40°C...+125°C	Packaging height	180,00 mm
		Packaging width	200,00 mm
		Packaging weight	3,86 kg
		Packaging volume	17,10 dm ³
		Packaging description	Carton box
		Packaging quantity	10 Pcs
		Packaging EAN code	8015747250023
		Sub-packaging weight	1,93 kg
		Sub-packaging description	Plastic packaging
		Sub-packaging quantity	5 Pcs
		Sub-packaging EAN barcode	8015747100946

Part number

JMPP 24.25



Catalogue drawings

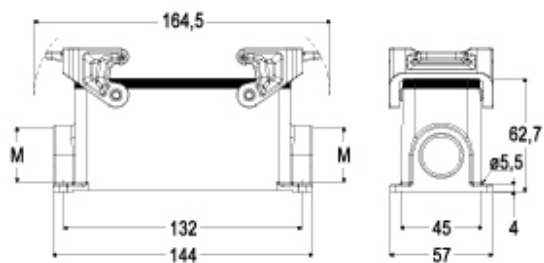

Notes

Dimensions shown in mm are not binding and may be changed without notice.
