

Part number

JMPP 16 L25



Surface mounting housing, JEI®-P series, with 1 lever, M25 cable entry, size 77.27

Product description

Product type	Surface mounting housing
Series	JEI®-P
Closing type	With 1 lever
Size	Size 77.27
Cable entry	With cable entry M25

Technical data

IP degree of protection IP65

Further technical details

Weight	1,00 g
Operating temperature range (min, max)	-40°C...+125°C

Material properties

Other materials	Lever: Polyamide (PA) Gasket: NBR
Colour	RAL 7040 grey

Approvals / Standards

Certifications DNV, BV

General ordering information

EAN13 code 8015747303682

Packaging Information

Packaging length	475,00 mm
Packaging height	180,00 mm
Packaging width	175,00 mm
Packaging volume	14,96 dm ³
Packaging description	Carton box
Packaging quantity	10 Pcs
Packaging EAN code	8015747027632
Sub-packaging description	Plastic packaging
Sub-packaging quantity	5 Pcs
Sub-packaging EAN barcode	8015747027649

Part number

JMPP 16 L25



Catalogue drawings

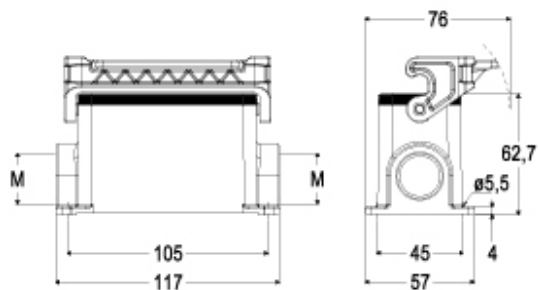

Notes

Dimensions shown in mm are not binding and may be changed without notice.
