

Part number

# JMPP 10.20



Surface mounting housing, JEI®-P series, with 2 levers, M20 cable entry, size 57.27

#### Product description

<b>Product type</b>	Surface mounting housing
<b>Series</b>	JEI®-P
<b>Closing type</b>	With 2 levers
<b>Size</b>	Size 57.27
<b>Cable entry</b>	With cable entry M20

#### Technical data

**IP degree of protection** IP65

#### Further technical details

<b>Weight</b>	220,00 g
<b>Operating temperature range (min, max)</b>	-40°C...+125°C

#### Material properties

<b>Other materials</b>	Lever: Polyamide (PA) Gasket: NBR
<b>Colour</b>	RAL 7040 grey

#### Approvals / Standards

<b>Certifications</b>	DNV, BV
-----------------------	---------

#### General ordering information

<b>EAN13 code</b>	8015747100786
-------------------	---------------

#### Packaging Information

<b>Packaging length</b>	250,00 mm
<b>Packaging height</b>	145,00 mm
<b>Packaging width</b>	300,00 mm
<b>Packaging weight</b>	4,40 kg
<b>Packaging volume</b>	10,88 dm <sup>3</sup>
<b>Packaging description</b>	Carton box
<b>Packaging quantity</b>	20 Pcs
<b>Packaging EAN code</b>	8015747100816
<b>Sub-packaging weight</b>	1,10 kg
<b>Sub-packaging description</b>	Plastic packaging
<b>Sub-packaging quantity</b>	5 Pcs
<b>Sub-packaging EAN barcode</b>	8015747100823

Part number

# JMPP 10.20



## Catalogue drawings

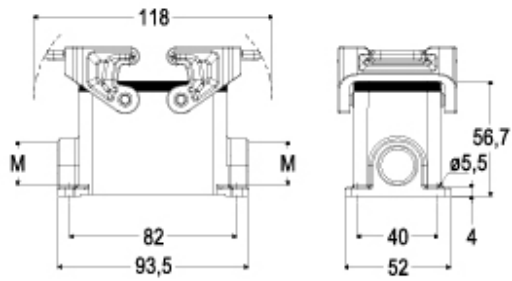

## Notes

Dimensions shown in mm are not binding and may be changed without notice.

---