

Part number

JMPAP 10.232



Surface mounting housing, JEI®-P series, with 2 levers, M32 x 2 cable entry, size 57.27, high construction

Product description		Material properties	
Product type	Surface mounting housing	Other materials	Lever: Polyamide (PA) Gasket: NBR
Series	JEI®-P	Colour	RAL 7040 grey
Closing type	With 2 levers	Approvals / Standards	
Size	Size 57.27	Certifications	DNV, BV
Cable entry	With cable entry M32 x 2	General ordering information	
Specification	High construction	EAN13 code	8015747219068
Technical data		Packaging Information	
IP degree of protection	IP65	Packaging weight	3,25 kg
Further technical details		Packaging volume	12,11 dm ³
Weight	296,00 g	Packaging description	Carton box
Operating temperature range (min, max)	-40°C...+125°C	Packaging quantity	10 Pcs
		Packaging EAN code	8015747268462
		Sub-packaging weight	1,63 kg
		Sub-packaging description	Plastic packaging
		Sub-packaging quantity	5 Pcs
		Sub-packaging EAN barcode	8015747268479

Part number

JMPAP 10.232



Catalogue drawings

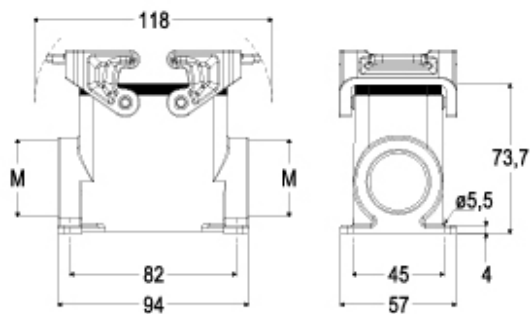

Notes

Dimensions shown in mm are not binding and may be changed without notice.