

Part number

JMPAP 06L232



Surface mounting housing, JEI®-P series, with 1 lever, M32 x 2 cable entry, size "44.27", high construction

Product description		Material properties	
Product type	Surface mounting housing	Colour	RAL 7040 grey
Series	JEI®-P	Approvals / Standards	
Closing type	With 1 lever	Certifications	DNV, BV
Size	Size 44.27	General ordering information	
Cable entry	With cable entry M32 x 2	EAN13 code	8015747219051
Specification	High construction	Packaging Information	
Technical data		Packaging length	475,00 mm
IP degree of protection	IP65	Packaging height	200,00 mm
Further technical details		Packaging width	150,00 mm
Weight	255,00 g	Packaging weight	2,55 kg
Operating temperature range (min, max)	-40°C...+125°C	Packaging volume	14,25 dm ³
		Packaging description	Carton box
		Packaging quantity	10 Pcs
		Packaging EAN code	8015747248662
		Sub-packaging weight	1,28 kg
		Sub-packaging description	Plastic packaging
		Sub-packaging quantity	5 Pcs
		Sub-packaging EAN barcode	8015747239929

Part number

JMPAP 06L232



Catalogue drawings

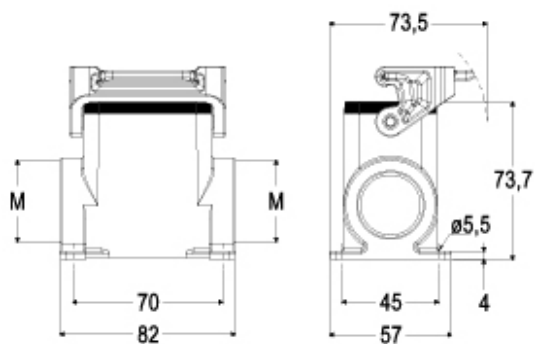

Notes

Dimensions shown in mm are not binding and may be changed without notice.
