

Part number

CX 01 30PEM



Male modular insert, Mixo series, 300 A, crimp connection, 1 PE pole, 2 modules, PE module for earth termination

Product description

Product type	Modular insert
Series	Mixo
Connection type	Crimp connection
Gender	Male
N. of poles	1 PE pole
Size	2 modules
Specification	For C30 contacts (16-70 mm ²) PE module for earth termination

Technical data

Current	300 A
IP degree of protection	IP20 without enclosure, IP65/IP66/IP68/IP69 with enclosure

Further technical details

Mating cycles	≥ 500
Contact resistance	≤ 0,2 mΩ
Weight	23,00 g
Operating temperature range (min, max)	-40 °C ... +125 °C
UL 94 flammability rating	V-0

Material properties

Main material	Polycarbonate
Colour	RAL 7032 grey
RoHs conformity	Compliant
China RoHs - EFUP	E
REACH SVHC substances	No

General ordering information

EAN13 code	8015747289863
eCl@ss 8.1	27440205
ETIM 7.0	EC000438

Packaging Information

Packaging weight	0,17 kg
Packaging volume	1,24 dm ³
Packaging description	Carton box
Packaging quantity	5 Pcs
Packaging EAN code	8015747290043
Sub-packaging length	112,00 mm
Sub-packaging height	95,00 mm
Sub-packaging width	117,00 mm
Sub-packaging weight	0,03 kg
Sub-packaging volume	1,24 dm ³
Sub-packaging description	Plastic bag
Sub-packaging quantity	1 Pcs
Sub-packaging EAN barcode	8015747290050

Part number

CX 01 30PEM



Catalogue drawings

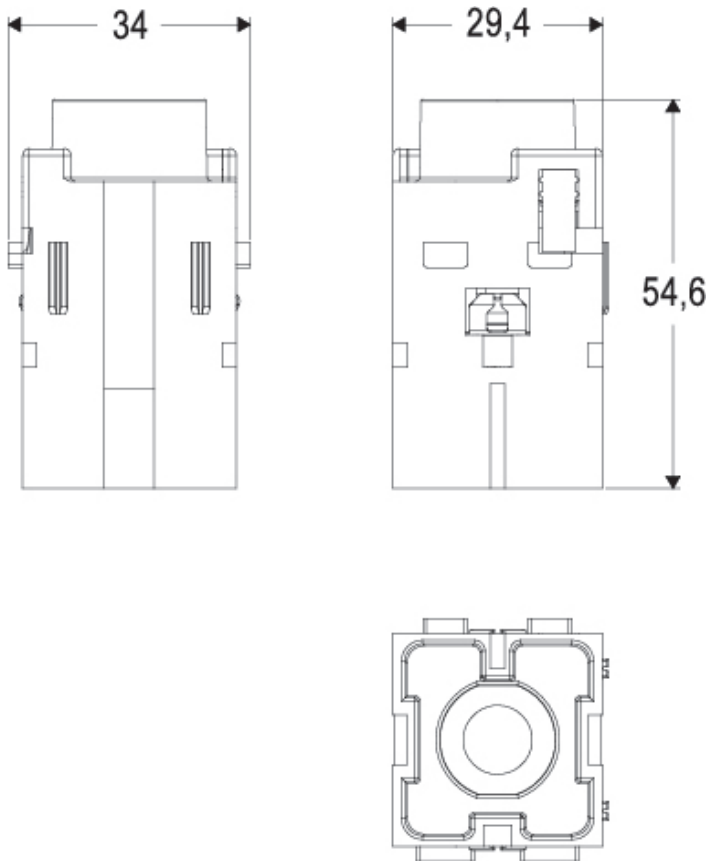

Notes

Standard modular inserts:

-in combination with standard contacts and standard frames (CX ... TF/TM); must be mounted either in traditional enclosures or in COB panel supports (both up to 500 matings).

Dimensions shown in mm are not binding and may be changed without notice.
