

Part number

CSEF 16 N



Female insert, CSE series, spring terminal connection, 16 poles + PE (17-32), 16 A 500 V 6 kV 3, size "77.62"

Product description		Material properties	
Product type	Insert	Main material	Polycarbonate (PC)
Series	CSE	Colour	RAL 7032 grey
Connection type	Spring terminal connection	RoHs conformity	Compliant with exemption 6(c): copper alloy containing up to 4% lead by weight
Gender	Female	China RoHs - EFUP	50
N. of poles	32 poles +	REACH SVHC substances	Yes Lead
Size	Size 77.62	SCIP number	1a9c93ff-0445-4a16-81e3-1609ac5274d6
Technical data		Approvals / Standards	
Current	16 A	Reference standard	EN 61984:2009-06
Voltage	500 V	Certifications	CSA, CQC, DNV, BV, EAC
Rated impulse withstand voltage	6 kV	UL	ECBT2
Pollution degree	3	General ordering information	
Rated voltage according to UL/CSA	600 V	EAN13 code	8015747094481
Wire cross-section	0,14 mm ² - 2,50 mm ²	ETIM 7.0	EC000438
AWG size	26 - 14	Packaging Information	
Contact type	Turned silver plated	Packaging length	230,00 mm
Pole numbering system	17-32	Packaging height	110,00 mm
IP degree of protection	IP20 without enclosure, IP65/IP66 with enclosure	Packaging width	180,00 mm
Further technical details		Packaging weight	2,77 kg
Characteristics according to EN 61984	16A 500V 6kV 3; 16A 400/690V 6kV 2	Packaging volume	4,55 dm ³
Mating cycles	≥ 500	Packaging description	Carton box
Insulation resistance	≥ 10 GΩ	Packaging quantity	30 Pcs
Contact resistance	≤ 3 mΩ	Packaging EAN code	8015747094498
Weight	89,00 g	Sub-packaging length	87,00 mm
Operating temperature range (min, max)	-40 °C ... +125 °C	Sub-packaging height	36,00 mm
Conductors stripping length	9...11 mm	Sub-packaging width	180,00 mm
UL 94 flammability rating	V-0	Sub-packaging weight	0,46 kg
		Sub-packaging volume	0,56 dm ³
		Sub-packaging description	Carton tray
		Sub-packaging quantity	5 Pcs
		Sub-packaging EAN barcode	8015747094504

Part number

CSEF 16 N



Catalogue drawings

Catalogue drawings

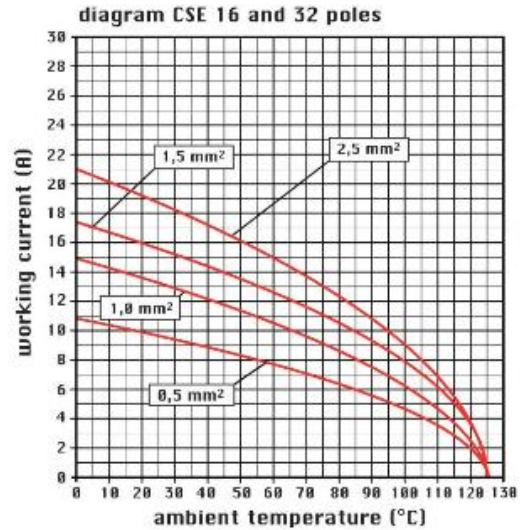
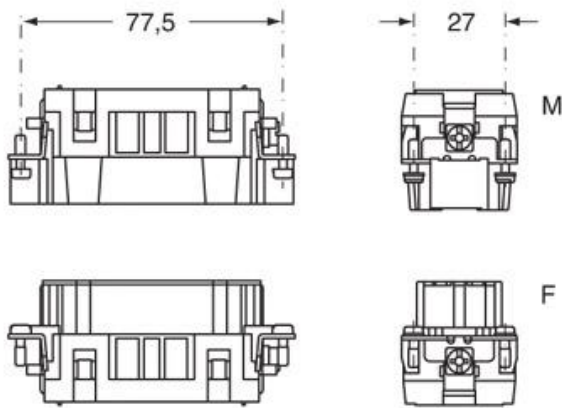

CSEF 16 N
CSEF 16

CSEM 16 N
CSEM 16

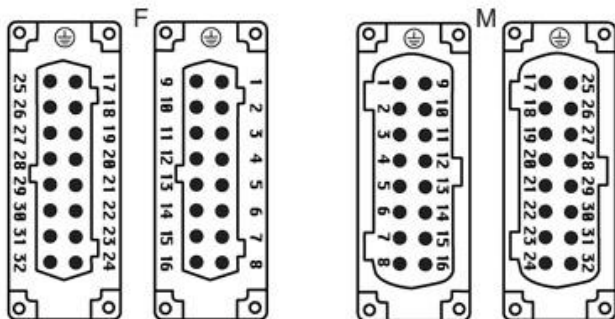

Notes

CSEF/M 16 N inserts:

- characteristics according to EN 61984:
(16A 500V 6kV 3)
(16A 400/690V 6kV 2)
- rated voltage according to UL/CSA: 600V
- insulation resistance: > 10 GOhm
- ambient temperature limit: -40 °C ... +125 °C
- are made of self-extinguishing thermoplastic resin UL 94 V0
- mechanical life: > 500 cycles
- contact resistance: < 3 mOhm
- enclosures: size "77.62":
- C-TYPE IP65/IP66

W-YPE aggressive environments

Dimensions shown in mm are not binding and may be changed without notice.

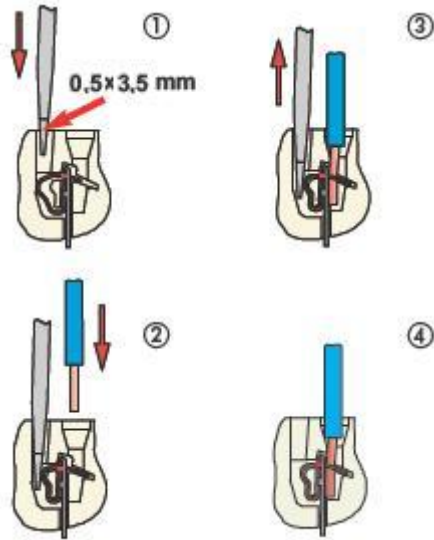

California Proposition 65 Information



WARNING

This product can expose you to lead and its compounds, known to the State of California to cause cancer and/or reproductive toxicity. For more information go to www.P65Warnings.ca.gov.

California Proposition 65 Information



WARNING

This product can expose you to lead and its compounds, known to the State of California to cause cancer and/or reproductive toxicity. For more information go to www.P65Warnings.ca.gov.