

Part number

# CSAHF 10



Female insert, CSAH series, SQUICH® spring terminal connection without tools, 10 poles + PE, 16 A 250 V 4 kV 3, size "49.16"

Product description		Material properties	
<b>Product type</b>	Insert	<b>Main material</b>	Polycarbonate (PC)
<b>Series</b>	CSAH	<b>Other materials</b>	Contacts: copper alloy
<b>Connection type</b>	SQUICH® spring terminal connection without tools	<b>Colour</b>	RAL 7032 grey
<b>Gender</b>	Female	<b>RoHs conformity</b>	Compliant with exemption 6(c): copper alloy containing up to 4% lead by weight
<b>N. of poles</b>	10 poles + 	<b>China RoHs - EFUP</b>	50
<b>Size</b>	Size 49.16	<b>REACH SVHC substances</b>	Yes Lead
Technical data		<b>SCIP number</b>	1a9c93ff-0445-4a16-81e3-1609ac5274d6
<b>Current</b>	16 A	Approvals / Standards	
<b>Voltage</b>	250 V	<b>Reference standard</b>	EN 61984:2009-06
<b>Rated impulse withstand voltage</b>	4 kV	<b>Certifications</b>	DNV, BV, EAC, CQC
<b>Pollution degree</b>	3	<b>UL</b>	ECBT2
<b>Rated voltage according to UL/CSA</b>	600 V	<b>cUL</b>	ECBT8
<b>Wire cross-section</b>	0,14 mm <sup>2</sup> - 2,50 mm <sup>2</sup>	General ordering information	
<b>AWG size</b>	26 - 14	<b>EAN13 code</b>	8015747214575
<b>Contact type</b>	Turned silver plated	<b>eCl@ss 8.1</b>	27440205
<b>IP degree of protection</b>	IP20 without enclosure, IP65/IP66 with enclosure	<b>ETIM 7.0</b>	EC000438
Further technical details		<b>Packaging Information</b>	
<b>Characteristics according to EN 61984</b>	16A 250V 4kV 3; 16A 230/400V 4kV 2	<b>Packaging weight</b>	1,62 kg
<b>Mating cycles</b>	≥ 500	<b>Packaging volume</b>	3,29 dm <sup>3</sup>
<b>Insulation resistance</b>	≥ 10 GΩ	<b>Packaging description</b>	Carton box
<b>Contact resistance</b>	≤ 3 mΩ	<b>Packaging quantity</b>	30 Pcs
<b>Weight</b>	47,00 g	<b>Packaging EAN code</b>	8015747214612
<b>Operating temperature range (min, max)</b>	-40 °C ... +125 °C	<b>Sub-packaging length</b>	127,00 mm
<b>Conductors stripping length</b>	9...11 mm	<b>Sub-packaging height</b>	45,00 mm
<b>UL 94 flammability rating</b>	V-0	<b>Sub-packaging width</b>	63,00 mm
<b>Tightening torque for PE connection</b>	M3,5: 0,8 Nm; 7,1 lb.in (Ph1 or 0,8 x 5,5 mm)	<b>Sub-packaging weight</b>	0,27 kg
		<b>Sub-packaging volume</b>	0,36 dm <sup>3</sup>
		<b>Sub-packaging description</b>	Carton tray
		<b>Sub-packaging quantity</b>	5 Pcs
		<b>Sub-packaging EAN barcode</b>	8015747214629

Part number  
**CSAHF 10**



Notes

Dimensions shown in mm are not binding and may be changed without notice.

**California Proposition 65 Information**



**WARNING**

This product can expose you to lead and its compounds, known to the State of California to cause cancer and/or reproductive toxicity. For more information go to [www.P65Warnings.ca.gov](http://www.P65Warnings.ca.gov).

**California Proposition 65 Information**



**WARNING**

This product can expose you to lead and its compounds, known to the State of California to cause cancer and/or reproductive toxicity. For more information go to [www.P65Warnings.ca.gov](http://www.P65Warnings.ca.gov).

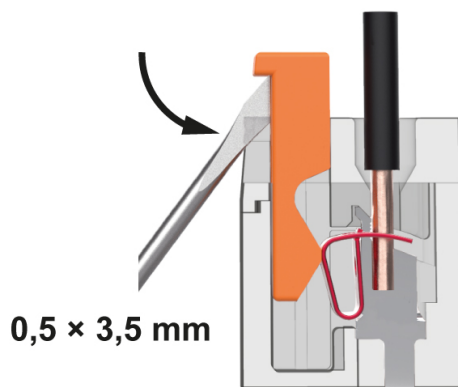
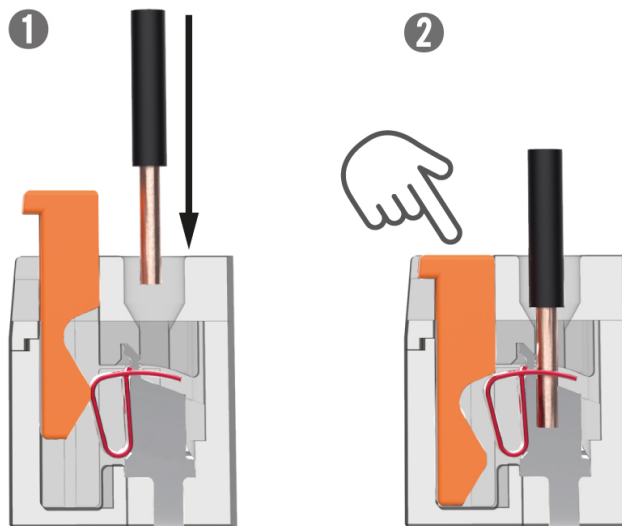

Reopening

SQUICH® connection with actuator button