

Part number

CR CPQ



Coding pin, red, for CDC, CQ, CQE, CCE, CMCE MIXO (16 A) inserts

Product description

Product type	Coding pin
Specification	For CDC, CQ, CQE, CCE, CMCE MIXO (16 A) inserts Plastic, red

Further technical details

Weight	0,25 g
Operating temperature range (min, max)	-40°C ... +125°C
UL 94 flammability rating	V-0

General ordering information

EAN13 code	8015747099585
eCl@ss 8.1	27440203
ETIM 7.0	EC002311

Packaging Information

Sub-packaging weight	0,03 kg
Sub-packaging description	Plastic bag
Sub-packaging quantity	100 Pcs
Sub-packaging EAN barcode	8015747143608

Part number

CR CPQ



Catalogue drawings

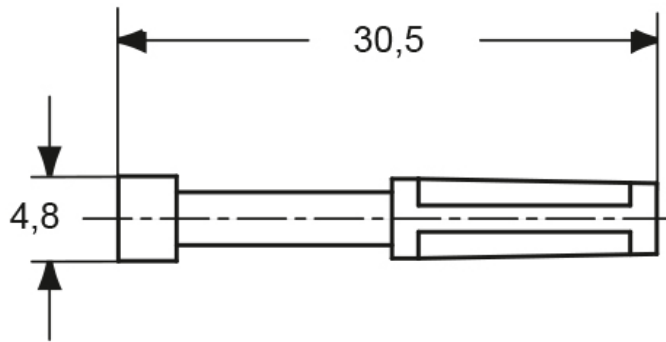

Notes

Dimensions shown in mm are not binding and may be changed without notice.
