

Part number

# COB TCQ



Insert carrier blocks for window mounting with snap fastening, COB panel supports series, for inserts with 27 mm screw fixing centre distance (short side)

Product description		Material properties	
<b>Product type</b>	Insert carrier blocks for window mounting with snap fastening	<b>Colour</b>	RAL 7032 grey
<b>Series</b>	COB panel supports	<b>RoHs conformity</b>	Compliant with exemption 6(c): copper alloy containing up to 4% lead by weight
<b>Specification</b>	For inserts with 27 mm screw fixing centre distance (short side)	<b>China RoHs - EFUP</b>	50
Technical data		<b>REACH SVHC substances</b>	Yes Lead
<b>IP degree of protection</b>	IP20	<b>SCIP number</b>	B008b8e4-629e-4e70-ab7d-b3b67464925d
Further technical details		<b>Approvals / Standards</b>	
<b>Weight</b>	42,00 g	<b>Certifications</b>	DNV, BV
<b>Operating temperature range (min, max)</b>	-40°C...+125°C	<b>UL</b>	ECBT2
		<b>cUL</b>	ECBT8
		<b>General ordering information</b>	
		<b>EAN13 code</b>	8015747036726
		<b>eCl@ss 8.1</b>	27440206
		<b>ETIM 7.0</b>	EC002312
		<b>Packaging Information</b>	
		<b>Packaging length</b>	200,00 mm
		<b>Packaging height</b>	165,00 mm
		<b>Packaging width</b>	200,00 mm
		<b>Packaging weight</b>	1,15 kg
		<b>Packaging volume</b>	6,60 dm <sup>3</sup>
		<b>Packaging description</b>	Carton box
		<b>Packaging quantity</b>	25 Pcs
		<b>Packaging EAN code</b>	8015747036733

Part number

# COB TCQ



Catalogue drawings

Catalogue drawings



## COB TCQ

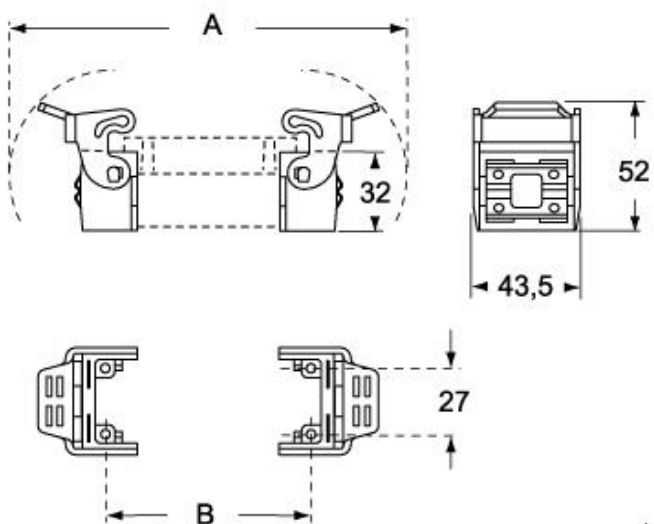

## Notes

Dimensions shown in mm are not binding and may be changed without notice.