

Part number  
**CGC 10**



Cover, IP68 series, with 2 screws, size "57.27"

Product description		Material properties	
<b>Product type</b>	Cover	<b>Main material</b>	Aluminium die-cast
<b>Series</b>	IP68	<b>Other materials</b>	Screws: Stainless steel
<b>Closing type</b>	With 2 screws	<b>Colour</b>	RAL 9005 black
<b>Size</b>	Size 57.27	<b>RoHs conformity</b>	Compliant
<b>Cable entry</b>	For housings	<b>China RoHs - EFUP</b>	E
Technical data		<b>REACH SVHC substances</b>	No
<b>IP degree of protection</b>	IP66 / IP68 / IP69	Approvals / Standards	
Further technical details		<b>Certifications</b>	DNV, BV
<b>Weight</b>	150,00 g	<b>UL</b>	ECBT2
<b>Operating temperature range (min, max)</b>	-40°C...+125°C	<b>cUL</b>	ECBT8
		General ordering information	
		<b>EAN13 code</b>	8015747141444
		<b>eCl@ss 8.1</b>	27440208
		<b>ETIM 7.0</b>	EC002314
		Packaging Information	
		<b>Sub-packaging length</b>	167,00 mm
		<b>Sub-packaging height</b>	21,00 mm
		<b>Sub-packaging width</b>	60,00 mm
		<b>Sub-packaging weight</b>	0,15 kg
		<b>Sub-packaging volume</b>	0,21 dm <sup>3</sup>
		<b>Sub-packaging description</b>	Carton tray
		<b>Sub-packaging quantity</b>	1 Pcs
		<b>Sub-packaging EAN barcode</b>	8015747141819

Part number

# CGC 10



Catalogue drawings

**CGC**

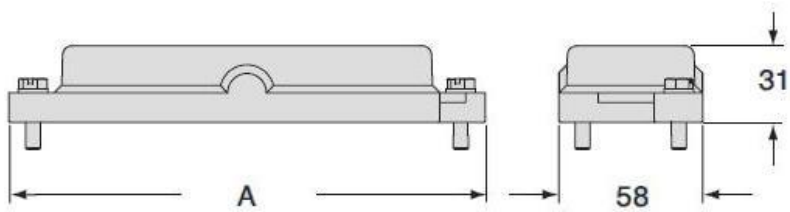

---

	<b>A</b>
<b>CGC 06</b>	133
<b>CGC 10</b>	146
<b>CGC 16</b>	166
<b>CGC 24</b>	193

---

## Notes

Dimensions shown in mm are not binding and may be changed without notice.

---