

Part number
SQ 1695



Interlocked switched socket-outlet, SQ series,
 3 poles + N + PE, 9 h (blue), 16 A, 120/208 ÷
 144/250 V

Product description

Product type	Interlocked switched socket-outlet
Series	SQ
N. of poles	3 poles + N + 
Clock position	9
Size	Socket centre distance 115 x 144 mm

Technical data

Current	16 A
Voltage	120/208 ÷ 144/250 V
IP degree of protection	IP44

Further technical details

Weight	442,00 g
Operating temperature range (min, max)	-25°C ... +40°C
IK rating (impact degree of protection)	IK08

Material properties

Colour	RAL 7035 grey, RAL 5015 blue
RoHs conformity	Compliant with exemption 6(c): copper alloy containing up to 4% lead by weight
China RoHs - EFUP	50
REACH SVHC substances	Yes Lead
SCIP number	Ce861c8d-b979-403b-96d9-80aef6dc281d

Approvals / Standards

Reference standard	EN 60309-1, -2 e -4
---------------------------	---------------------

General ordering information

EAN13 code	8015747084536
-------------------	---------------

Packaging Information

Sub-packaging length	116,00 mm
Sub-packaging height	113,00 mm
Sub-packaging width	142,00 mm
Sub-packaging weight	0,44 kg
Sub-packaging volume	1,86 dm ³
Sub-packaging description	Carton box
Sub-packaging quantity	1 Pcs
Sub-packaging EAN barcode	8015747084543

Part number

SQ 1695



Catalogue drawings

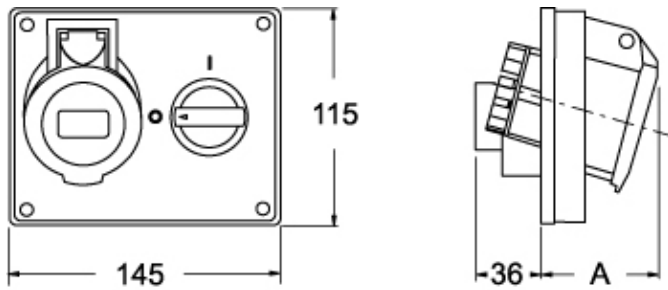

SQ		A
16A	2P+⊕	59
	3P+⊕	63
	3P+N+⊕	63

