

Part number

PEW 16114PQF



Flush-mounting socket outlet, PLUSO series, 3 poles + PE, 11 h (red), 16 A, 440 ÷ 460 V, inclined, with bigger flange

Product description

Product type	Socket Flush-mounting
Series	PEW...PQF, PLUSO
N. of poles	3 poles + 
Clock position	11
Specification	Inclined, bigger flange

Technical data

Current	16 A
Voltage	440 ÷ 460 V
IP degree of protection	IP67

Further technical details

Operating temperature range (min, max)	-25°C ... +40°C
---	-----------------

Material properties

Colour	RAL 7035 grey, RAL 3000 red
---------------	-----------------------------

Approvals / Standards

Reference standard	EN 60309-1 and -2
---------------------------	-------------------

General ordering information

EAN13 code	8015747156493
-------------------	---------------

Part number

PEW 16114PQF



Catalogue drawings

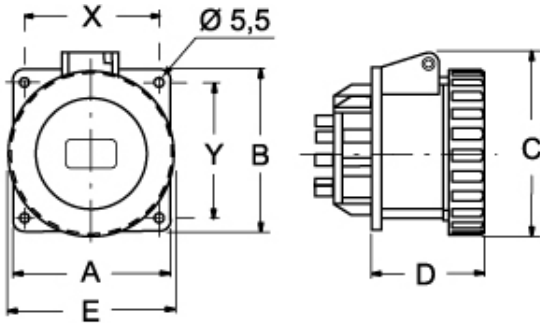

		A	B	C	D	E	X	Y
PQF 16 A	2P+⊖	80	80	--	52	70	60	60
	3P+⊖	80	80	--	52	78	60	60
PQ 16 A	2P+⊖	65	65	77	52	70	52	52
	3P+⊖	65	65	85	52	78	52	52
	3P+N+⊖	80	80	93	52	86	60	60
PQ 32 A	2P+⊖	80	80	98	62	92	60	60
	3P+⊖	80	80	98	62	92	60	60
	3P+N+⊖	80	80	105	62	100	60	60