

Part number

PE 3263 PQ



Flush-mounting socket outlet, PLUSO series, 2 poles + PE, 6 h (blue), 32 A, 200 ÷ 250 V, straight

Product description

Product type	Socket Flush-mounting
Series	PE...PQ, PLUSO
N. of poles	2 poles + 
Clock position	6
Size	Socket fixing centre distance 60 x 60 mm
Specification	Straight

Technical data

Current	32 A
Voltage	200 ÷ 250 V
IP degree of protection	IP44
Further technical details	
Weight	175,00 g
Operating temperature range (min, max)	-25°C ... +40°C

Material properties

Colour	RAL 7035 grey, RAL 5015 blue
RoHs conformity	Compliant with exemption 6(c): copper alloy containing up to 4% lead by weight
China RoHs - EFUP	50
REACH SVHC substances	Yes Lead
SCIP number	Ca7de37f-add8-4b77-9861-279c94903ade

Approvals / Standards

Reference standard	EN 60309-1 and -2
---------------------------	-------------------

General ordering information

EAN13 code	8015747067171
-------------------	---------------

Packaging Information

Packaging length	255,00 mm
Packaging height	195,00 mm
Packaging width	245,00 mm
Packaging weight	2,00 kg
Packaging volume	12,18 dm ³
Packaging description	Carton box
Packaging quantity	10 Pcs
Packaging EAN code	8015747067188

Part number

PE 3263 PQ



Catalogue drawings

(16 / 32A) PE ... PQ

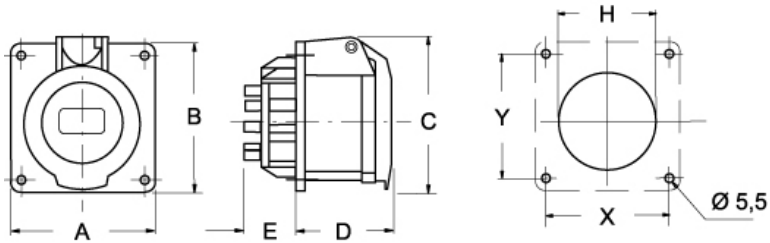

PE ... PQ	A	B	C	D	E	H	X	Y
16A 2P+⊖	65	65	71	52	27	60	52	52
	65	65	75	53	27	61,5	52	52
	80	80	86	53	27	70	60	60
32A 2P+⊖	80	80	87	62	28	68	60	60
	80	80	87	62	28	68	60	60
	80	80	92	62	28	73	60	60