

Part number

PE 3233 SM



Wall-mounting plug, PLUSO series, 2 poles + PE, 3 h (white), 32 A, 50 ÷ 250 V

| Product description | | Material properties | |
|---|---|------------------------------|---|
| Product type | Plug Wall-mounting | Colour | RAL 7035 grey, RAL 9010 white |
| Series | PE...SM, PLUSO | RoHs conformity | Compliant with exemption 6(c): copper alloy containing up to 4% lead by weight |
| N. of poles | 2 poles +  | China RoHs - EFUP | 50 |
| Clock position | 3 | REACH SVHC substances | Yes Lead |
| Technical data | | SCIP number | Ca7de37f-add8-4b77-9861-279c94903ade |
| Current | 32 A | Approvals / Standards | |
| Voltage | > 50 ÷ 250 V | Reference standard | EN 60309-1 and -2 |
| IP degree of protection | IP44 | General ordering information | |
| Further technical details | | EAN13 code | 8015747066501 |
| Weight | 243,00 g | Packaging Information | |
| Operating temperature range (min, max) | -25°C ... +40°C | Packaging length | 330,00 mm |
| | | Packaging height | 175,00 mm |
| | | Packaging width | 295,00 mm |
| | | Packaging weight | 2,75 kg |
| | | Packaging volume | 17,04 dm ³ |
| | | Packaging description | Carton box |
| | | Packaging quantity | 10 Pcs |
| | | Packaging EAN code | 8015747066518 |

Part number

PE 3233 SM



Catalogue drawings

(16 / 32A) PE ... SM

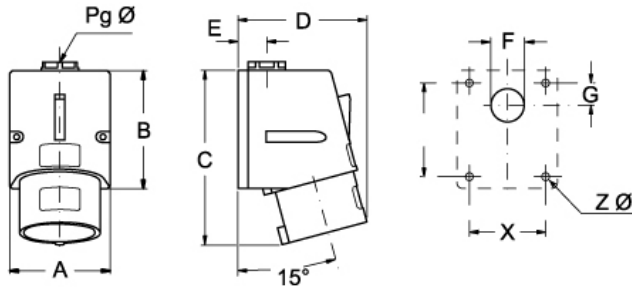

| PE ... SM | A | B | C | D | E | F | G | X | Y | Z Ø | Pg Ø | |
|------------|--------|----|-----|-----|----|----|----|----|----|-----|------|----|
| 16A | 2P+⊕ | 70 | 82 | 115 | 75 | 20 | 23 | 16 | 53 | 65 | 4,5 | 16 |
| | 3P+⊕ | 70 | 82 | 117 | 75 | 20 | 23 | 16 | 53 | 65 | 4,5 | 16 |
| | 3P+N+⊕ | 70 | 82 | 121 | 90 | 20 | 23 | 16 | 53 | 65 | 4,5 | 16 |
| 32A | 2P+⊕ | 86 | 104 | 145 | 95 | 24 | 29 | 17 | 61 | 79 | 6,5 | 21 |
| | 3P+⊕ | 86 | 104 | 145 | 95 | 24 | 29 | 17 | 61 | 79 | 6,5 | 21 |
| | 3P+N+⊕ | 86 | 104 | 147 | 95 | 24 | 29 | 17 | 61 | 79 | 6,5 | 21 |