

Part number

FM 32 MT



Box system carrying handle, FM series



Product description

Product type Box system carrying handle

Series FM

Further technical details

Weight 45,00 g

Operating temperature range (min, max) -40°C ... +125°C

Material properties

Colour RAL 7035 grey

General ordering information

EAN13 code 8015747047463

Packaging Information

Sub-packaging weight 0,05 kg

Sub-packaging description Plastic packaging

Sub-packaging quantity 1 Pcs

Sub-packaging EAN barcode 8015747047470

Part number FM 32 MT



Catalogue drawings

FM complementary parts and accessories



Box system carrying handle
Climbing irons for box fixing



DIN-rail EN 60715 - Insulated terminal block
Collar - Screws kit - Adhesive label



Description	Part No.	Part No.
Box system carrying handle - For 3236, 2451, 3251, 3221 and 4272 boards	FM 32 MT	
Climbing irons for external wall mounting - For 3236, 2451, 3251, 3221 and 4272 boards	BC SFT	
Sized DIN-rail EN 60715 (35 mm) With back plates for the positioning at different depths and fixing screws - For 2451 boards - For 3236, 3251, 3221 boards - For 4272 boards		FM GD 18 FM GD 25 FM GD 35
Insulated terminal block, 3 P 25 mm² + 10 P 10 mm² - For neutral and/or ground, compliant with EN 60998-2-1, stackable (up to 2 units)		FM 2510 MI
collar - for format 1043 box system		FM 1043 CO
screws kit - for mounting sockets PQ-PI-PQF-PIF series		FM 416
adhesive label - for the identification of the mounted modular devices		FM 18 ET

Dimensions in mm

FM 32 MT

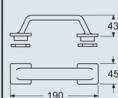

BC SFT

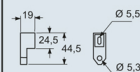

Dimensions in mm

FM GDxx

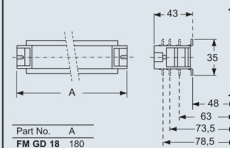

FM 2510 MI

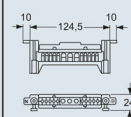

Dimensions indicated are not binding and may be changed without prior notice.