

Part number

# CMAP 16 CP29



Surface mounting housing, 830V series, with 4 pegs, Pg29 cable entry, size "104.27", high construction, with plastic cover

|   |                                       |                                     |                   |
|---|---------------------------------------|-------------------------------------|-------------------|
| <b>Product description</b>                    |                                       | <b>Material properties</b>          |                   |
| <b>Product type</b>                           | Surface mounting housing              | <b>Colour</b>                       | RAL 7040 grey     |
| <b>Series</b>                                 | 830V                                  | <b>RoHs conformity</b>              | Compliant         |
| <b>Closing type</b>                           | With 4 pegs                           | <b>China RoHs - EFUP</b>            | E                 |
| <b>Size</b>                                   | Size 104.27                           | <b>REACH SVHC substances</b>        | No                |
| <b>Cable entry</b>                            | With cable entry<br>Pg29              | <b>Approvals / Standards</b>        |                   |
| <b>Specification</b>                          | High construction, with plastic cover | <b>Certifications</b>               | DNV, BV           |
| <b>Technical data</b>                         |                                       | <b>UL</b>                           | ECBT2             |
| <b>IP degree of protection</b>                | IP65                                  | <b>cUL</b>                          | ECBT8             |
| <b>Further technical details</b>              |                                       | <b>General ordering information</b> |                   |
| <b>Weight</b>                                 | 418,00 g                              | <b>EAN13 code</b>                   | 8015747029438     |
| <b>Operating temperature range (min, max)</b> | -40°C...+125°C                        | <b>Packaging Information</b>        |                   |
|   |                                       | <b>Sub-packaging weight</b>         | 2,09 kg           |
|   |                                       | <b>Sub-packaging description</b>    | Plastic packaging |
|   |                                       | <b>Sub-packaging quantity</b>       | 5 Pcs             |
|   |                                       | <b>Sub-packaging EAN barcode</b>    | 8015747104647     |

Part number

# CMAP 16 CP29



Catalogue drawings

## CMP CMAP - MMP MMAP

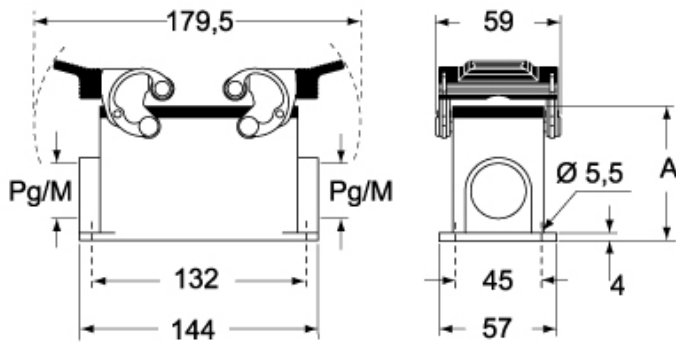

## CMP CS/CP CMAP CS/CP - MMP CS/CP MMAP CS/CP

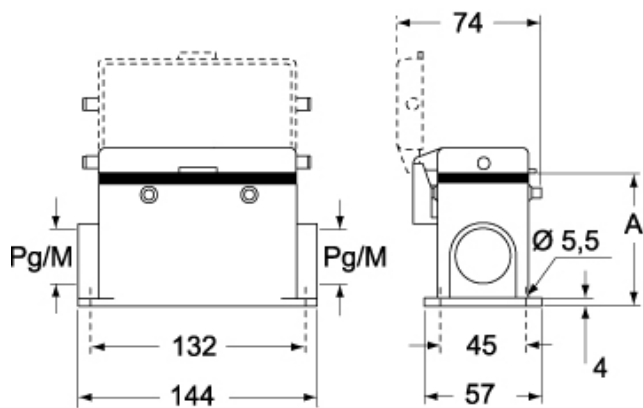

|                          | <b>A</b> |
|--------------------------|----------|
| <b>CMP / MMP</b>         | 63       |
| <b>CMAP / MMAP</b>       | 80       |
| <b>CMP CS / MMP CS</b>   | 63       |
| <b>CMAP CS / MMAP CS</b> | 80       |
| <b>CMP CP / MMP CP</b>   | 63       |
| <b>CMAP CP / MMAP CP</b> | 80       |